

May 11, 2019

Allen County War Memorial Coliseum



Show Directory and Program Guide

Hosted by:

AWS
FOUNDATION

Artwork by Abigail Deuter
at Passages, Inc.

Could a Wheelchair Accessible Vehicle or Lift **HELP YOU** Gain Added Mobility?



Wheelchair Van Rentals

1-844-648-RENT

Try Before You Buy!

Great rates - Daily / Weekly / Monthly!

**Wheelchair Accessible
Van & SUV Conversions**
- New & Pre-owned -



Come See the All-New VMI Honda Pilot!

**Wheelchair and
Scooter Lifts**



**Mobility
Seating**

Superior[®]
Van & Mobility



Making Mobility Possible!

Consumer / Commercial
SALES - SERVICE - RENTALS

2218 Contractors Drive, Fort Wayne

1-877-497-VANS (8267)

For all your mobility
transportation needs 24/7...

www.SUPERIORVAN.com

WELCOME



Welcome to the 10th annual disABILITIES Expo! We are so happy you joined us to celebrate our 10th year. This event continues to grow thanks to people like you who show up for the fun day of opportunities, performances, and friendship.

This day has been planned just for you with more than 115 exhibitors to make this a one-stop resource for all types of disability services and products. We hope that you find what you need, and even more importantly, discover new resources to enhance your quality of life.

The Expo is also filled with fun and entertaining events, spectacular adaptive sports exhibitions and special guests making a difference in the disability world. This year, we are excited to introduce IndiandisabilityResourceFINDER.org and a scavenger hunt!

Helping you explore opportunities, expand possibilities and experience everything is what the disABILITIES Expo is all about. Spend a few hours or the entire day...we're glad you are here!

ABOUT THE COVER ART

To celebrate our 10th Anniversary, we held a cover art contest. Applicants submitted their interpretation of the celebration and the AWS Foundation staff voted on their favorite. The winner is Abigail (Abby) Deuter. She is a consumer at Passages in Columbia City. Abby's design included a unique take on the disABILITIES Expo logo and fireworks symbolizing celebration. The staff felt this image captured the celebratory spirit.

If you would like a 10th Anniversary disABILITIES Expo commemorative poster including Abby's art, you can pick one up for **FREE** at the Info booth.



PLANNING COMMITTEE

Andie Mosley
AWS Foundation

Ashley Gettys
Easterseals Arc

Candy Pease
Positive Pathways

Jamie Mann
Easterseals Arc

Julie Weingartner
Parent, Turnstone

Kathy Morse
Leisure for Life

LaToya Allen
Vocational Rehabilitation Services

Laura Lindsay
The League

Lori Bones
Aging and In-Home Services

Tina Acosta
Turnstone

Tom Steigmeyer
WLDE 101.7/WAJI 95.1

Tommy Guest
Partners in Autism

Traci Garman
Superior Van and Mobility

Randy Wolf
Goodwill

AWS Foundation is pleased to host the 2019 disABILITIES Expo, the only event of its kind in the tri-state area. Our mission is to help children and adults with enduring intellectual, developmental, and physical disabilities live as independently as possible, be included in the community and function at their highest potential. Since our grant making began in 2009, the Foundation has awarded grants totaling \$19.8 million to more than 150 northeast Indiana organizations working with individuals with disabilities and their families.

We extend a very special thanks to these sponsors and partners:

Inclusion and Main Stage Sponsor

Superior Van and Mobility
Anthem Blue Cross & Blue Shield
Greater Fort Wayne Inc.
FINDER/ www.IndianaDisabilityResourceFINDER.org

Event Sponsors

AutoFarm Mobility
National Seating & Mobility, Inc.

Expo Hall Sponsors

Easterseals Arc of Northeast Indiana
Meridian Health Services
Pathfinder Services
PQTrains/Windrose Urban Farms
Prevail Prosthetics & Orthotics, Inc.
ResCare

Activities Sponsors

AID Residential
APM Medical Supplies
Bath Fitter
Byron Health Center
Fort Wayne Autism Center
Fort Wayne Metropolitan Human Relations Commission
Forte Residential, Inc.
Goodwill Industries of Northeast Indiana, INC.
Hand in Hand Comprehensive Therapy Specialists, Inc.
IPMG (Indiana Professional Management Group)

Kelsey Chiropractic and Neurofeedback LLC
LEL Home Services
Midwest Transit Equipment
Ministry with Persons with Disabilities,
Diocese of Fort Wayne-South Bend
Numotion
Pure Abilities Recreational Therapy
Uniquehab Solutions
Visiting Nurse
YMCA of Greater Fort Wayne

HELPING PEOPLE MOVE THROUGH LIFE.



National Seating & Mobility (NSM) brings together industry-leading expertise, uniquely engineered systems and breakthrough technologies to provide products and services that help our clients move through life. NSM is the only national provider of complete mobility solutions with a national network of professionals and dedicated specialists focused on Complex Rehab Technology (CRT), Home & Vehicle Accessibility, and Service.

For more information
about NSM services
contact:

510 Incentive Dr
Ft. Wayne, IN 46825-3376
Phone (260) 489-5200
Fax (260) 489-4001



**NATIONAL
SEATING &
MOBILITY**

LET'S GET *moving*

Hour-by-Hour

10th Annual
disABILITIES
EXPO 

Main Stage

10:00am One Heart Bells and Voices Choir
10:30am Huntington University Undignified
11:00am Jesters Presentation
11:50am Musical Buddies
1:15pm Joyful Songsters
1:45pm Soul Brothers & Soul Sisters



Sports Center

10:30am Paralympic Sports Panel
11:20am Dazzlers Cheerleading Performance
11:35am Dance Collective *Limitless* Performance
12:15pm Turnstone Goalball Clinic
1:00pm Turnstone Goalball Clinic
2:15pm Turnstone Goalball Clinic



Mark's Ark - Show times at 11:00am & 1:00pm

An interactive exotic animal presentation and petting zoo for family fun. Mark will be showing his animals and everyone is encouraged to pet the animals and just have fun!



All Day Activities at the Expo

Find what you need from local, regional and national companies representing a wide range of services and products with the knowledge and resources to enhance your quality of life — for every ability at every age and stage of life.

Scavenger Hunt

To add a little fun to our 10th year celebration, we are sending you on a scavenger hunt for a fun prize. You will look for 10 items/tasks, then head to the FINDER booth to claim your prize. For instructions to play, see six pages ahead of this page, or pick up a sheet at the Info Booth. Good luck!

Art Exhibit and Sale

Experience art in its various forms, styles and subject matter. It is all on display with many pieces for sale showcasing the artistic talents of individuals with disabilities in Northeast Indiana.

Photography Partnership Project Exhibit

It is said that a picture speaks 1,000 words. These images not only speak, they create emotion. The people in these exhibit photos show that individuals living with disabilities are strong, confident, successful and, most of all, happy. Portraits of individuals with disabilities, photographed by University of Saint Francis visual arts students, will capture Expo-goers' hearts.

Photo Booth

Stop by Superior Van & Mobility to have some fun at the photo booth. The booth is free and fun for all!



AutoFarm



Mobility



Mobility Vans, Scooters, Lift Chairs

SALES - SERVICE - RENTALS

765.354.2261

autofarmmobility.com

Guest Performances



Jesters

Founded in 1979, the University of Saint Francis Jesters provides multi-disciplinary performing arts opportunities to people with intellectual/developmental disabilities (I/DD), ages 8-senior citizens. The Jesters program features a summer exploration, a core academic year program with an original culminating performance and guest artist residencies. In 2017, the Jesters presented artists from Second City Theatre Chicago who taught workshops on improvisational skills to people with I/DD. During 2018, the Jesters has launched a new integrated improv group comprised of people with and without disabilities. This year's lecture-demonstration will feature improv games presented by people with I/DD who are part of this new performing group.

Dazzlers Cheerleading Squad

The Whitley County Dazzlers Cheerleading Squad is in their 8th season with nearly 30 team members. This year the team performed in Orlando and spent a day at Disney enjoying each other. It's fun and friendship with a little exercise thrown in for a great show of spirit.



One Heart Bells and Voices Choir

One amazing thing about music is that it can affect people of all ages and abilities. Including both voice and bells into One Heart's choir brings joy to the faces of performers as they play and to the audience too!

Undignified

This inclusive dance group is made up of students in the Huntington University ABLE program and their peers. We are excited to have them on our Main Stage for the first time at the disABILITIES Expo.

Joyful Songsters

Joyful Songsters is a community choir open to all teens and adults with no audition required. The program is designed to provide an integrated choral experience for individuals with disabilities, senior citizens, and other teens and adults living in Huntington County. Choir members promote a sense of community involvement within their group and throughout the community while participating in high quality music learning and performance. They are currently accepting new singers with or without disabilities. Participation is free.

Premiere Dance Company: Soul Brothers & Soul Sisters

Premiere Dance Company believes every child can be a dancer and have FUN while learning. They pride themselves on their caring, conservative, and kind environment. Every child is an artist in their own way and this group embraces individual personality and style!

The Musical Buddies

The Musical Buddies, under the direction of Heather Palmer, is a young adults choir. The choir not only provides them with the opportunity to work on social skills with their friends but also the benefit of advocating for themselves and showing our community that they can do anything they put their mind to. They have performed at Sweetwater, the ASI Autism Acceptance Walk, the 2017 disABILITIES Expo, the IPFW Autism Celebration, and nursing homes throughout the area to name a few. The Musical Buddies are honored to be asked to perform on WBOI's Meet the Music program this summer!



Numotion is the leading provider of Complex Rehab Technology (CRT) in the United States. From manual and powered wheelchairs to disposable medical supplies that serve unique medical and functional needs, we are helping people of all ages live more freely.

1901 Production Rd
Fort Wayne, Indiana 46808
(260) 471-0206 phone • (260) 471-5109 fax

numotion
Mobility starts here.

ipmg

My company,
Your company,
Our company!

100% Employee-Owned Since 2017

**Facilitating Success through
Person-Centered Case Management**



Customer Service: 866-672-4764
customerservice@gotoipmg.com
www.gotoipmg.com



**DO YOU HAVE A
A BRAIN MAP CA
CALL (260) 432-87
LIMITED OPENIN**



PURE ABILITIES
RECREATIONAL THERAPY

PUREABILITIES@GMAIL.COM
330.441.2258



PUREABILITIES.COM



In the Art Center

Regional Special Arts Exhibit and Sale

Don't miss this opportunity to enjoy and shop these wonderful, artistic creations. Curated By:



Photography Partnership Project Exhibit

Portraits of individuals with disabilities, photographed by University of Saint Francis visual arts students, will capture Expo-goers' hearts and provide a glimpse into what makes the subject matter so special. We express our thanks and appreciation to Professor Cara Wade and the visual art students for capturing these images.

Together we achieve more.



Counseling
• Couples Counseling
• Family Therapy
• Individual Therapy
• Child-Play Based Therapy

Counseling Services

At Hand In Hand we focus on providing quality therapy services to assist in meeting your goals. We can deal with emotional trauma, relationship enhancement, mood improvement, marital discord, divorce/separation, substance abuse, parenting, family conflict, grief and much more.

Call Today
260.497.0328

Most Insurance Accepted



Pediatric Therapy

Parents play an important role in their child's development. Hand In Hand assists you in articulation, fine-motor skills, gross-motor skills, feeding difficulties, sensory issues, genetic disorders, traumatic brain injuries, developmental delays, and much more.

Pediatric Therapy
• Occupational Therapy
• Physical Therapy
• Speech Therapy



HIH

9426 Lima Rd., Suite A
Fort Wayne
handinhandtherapy.com

Hand In Hand provides First Steps services for 12 counties in NE Indiana

CONNXXIONS

Coordinated Care for the Dually Diagnosed

For persons with intellectual or developmental disorders and mental health needs.



Individuals with intellectual/developmental disorders and mental health needs face unique challenges.

Meridian Health Services' Connxxions Program is specially designed to improve the individual's coping skills and overall well-being.



Services may include:

Individual therapy
Group Skill Building
Case management
Mental Health Skill Building
Psychiatric services
24-Hour Crisis Services

*Services do not use Medicaid Waiver funds; They are funded through Medicaid Rehabilitation Option (MRO).

To enroll in the
Connxxions Program
contact
Meridian Health Services at
866-306-2647

MERIDIAN
HEALTH Services

Physical. Mental. Social Well-Being.

MeridianHS.org



Creating Unique Solutions Together



UniqueHab Solutions was created to meet the unique needs of families and their loved ones with physical and intellectual disabilities. We are dedicated to enhancing and full-filling the dreams and opportunities of children and adults with physical and intellectual disabilities to live as independently as achievable, be included in the community and function at their maximum possible level.

5508 Saint Joe Road Fort Wayne, Indiana 46835
www.uniquehabsolutions.com
Phone: 260-203-2077
Fax: 260-203-2101
Email: info@uniquehab.com

Forte

**RESIDENTIAL &
HOME HEALTH CARE**
employee owned

"Serving
individuals with
disabilities in
their homes
since 1992."



forteresidential.org
574-549-9961



Prevail

Prosthetics and Orthotics

A Community Supporter of Muncie and Anderson Since 1989

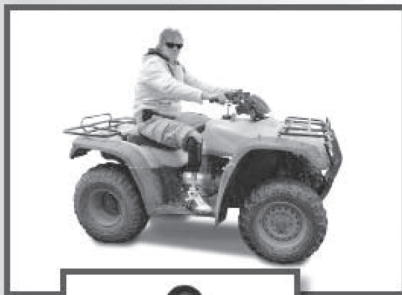

Let us
help you
Prevail

1-800-745-3295



Facilities Located in

- Muncie
- Anderson
- Indianapolis
- Fort Wayne

**Compassionate Prosthetic
and Orthotic Care**
www.prevailpando.com

Scavenger Hunt

1. Find a stress ball.
2. Take a picture at the Superior Van photo booth.
3. Visit the Art Exhibit & Sale. Take a picture with a sign that says "Art Exhibit & Sale" (Do not take a photo of any art pieces).
4. Get a business card.
5. Find a pen from an exhibitor.
6. Watch a stage performance or sports demonstration and take a picture of who you watched.
7. Find a piece of candy.
8. Find a bracelet.
9. Visit Mark's Ark and take a picture of your favorite animal.
10. Get a toy from an exhibitor.

**When you've found everything, take them over to the FINDER table
at Booth #1 and claim your prize. Good luck and HAVE FUN!**

APM Medical Supplies

Struggling with UTIs? Sterile catheter kits reduce your chance for infection. We do all the paperwork and bill your insurance or Medicare. Call APM Medical at (844)743-7373 or email info@apm-med.com



Our stories may be different, but we all have equal rights.

Are you being treated differently because of your color, race, national origin, disability, religion, gender, ancestry, age or sex?

At Metro: It's our job to enforce civil rights laws in the City of Fort Wayne. If you believe you are the victim of discrimination, contact Metro today to speak with a local investigator.

Learn about your rights!

260-427-1146
FortWayneMetro.org



Embracing differences. Empowering people.

Easterseals Arc is committed to supporting people with disabilities and empowering them to achieve their goals.

Easterseals Arc offers programs and services that help individuals:

- ◆ **Live** independent lives
- ◆ **Learn** skills to develop and thrive
- ◆ Prepare for **work** in the community
- ◆ Relax and socialize at **play**

Learn more about Easterseals Arc at www.eastersealsarcnein.org.



An Introduction to Medicaid Waivers

What are Medicaid Waivers?

- Medicaid Waivers allow Medicaid to fund supports and services for children and adults with disabilities in their family homes or communities instead of institutions.
- Medicaid Waivers allow an individual to use traditional Medicaid services AND the additional services available under a waiver.

What Medicaid Waivers are available in Indiana?

Developmental Disabilities Waivers

1. Family Supports Waiver (FS Waiver)
 - Provides home and community-based supports for individuals who have intellectual or other developmental disabilities, including autism.
2. Community Integration and Habilitation Waiver (CIH Waiver)
 - Provides home and community-based supports for individuals who have intellectual or other developmental disabilities, including autism.
 - The level of services available is based upon the individual's level of need and living situation.

Division of Aging Waivers

1. Aged & Disabled (A&D) Waiver
 - Provides an alternative to nursing facility admission for adults and persons of all ages with a physical disability.
 - The waiver is designed to provide services to supplement informal supports for people who would require care in a nursing facility if waiver or other supports were not available.
 - Waiver services can be used to help people remain in their own homes, as well as assist people living in nursing facilities to return to community settings such as their own homes, apartments, assisted living or Adult Family Care.
2. Traumatic Brain Injury (TBI) Waiver
 - Provides home and community-based services to individuals who, but for the provision of such services, would require institutional care.
 - Through the use of the TBI, the Indiana Office of Medicaid Policy and Planning and the Indiana Division of Aging seek to increase availability and access to cost-effective traumatic brain injury waiver services to people who have suffered a traumatic brain injury.

How do you qualify?

- You must meet Indiana's Medicaid disability and financial eligibility requirements.
- Your family income and assets are NOT counted to determine eligibility for children under 18; however, assets or income in the child's name ARE counted. For those older than 18, only the individual's income and assets are counted.
- You must require the type of care that ordinarily would be provided in a Medicaid-funded facility, such as a nursing home, large residential facility or group home.

Where do you apply?

- Adults and children with intellectual or other developmental disabilities: Obtain the number for your local Bureau of Developmental Disabilities Services (BDDS) office by calling **800-545-7763**.
- Adults and children with medical needs requiring skilled nursing care/TBI: Obtain the number for your local Area Agency on Aging by calling **800-986-3505**.

What other supports are available to people with disabilities?

- | | |
|-------------------------------------|---|
| • Medicaid | • Vocational Rehabilitation |
| • Health Insurance/Medical Supports | • Supplemental Security Income (SSI) |
| • Caregiver Support | • Medicaid Funded Group Homes |
| • First Steps | • Natural Supports and Community Programs |
| • Early Childhood Education | |
| • Special Education | |

About ResCare Indiana

ResCare Indiana has been helping individuals to reach their highest level of independence for more than 40 years. We are an industry-leading provider of residential services for individuals with intellectual and developmental disabilities (I/DD) including seniors. Over 800 of our dedicated and compassionate residential employees serve over 1,700 individuals daily. **If you know of any individuals needing residential services, please reach out to one of the ResCare Indiana operations below.**

ADULT SERVICES

- Residential Services
- ICF, Waiver, & Periodic Services
- Behavioral Support Services
- Day Programs/Sheltered Employment
- Outpatient Mental Health Services
- Respite Care
- Host Homes/Structured Family Caregiving
- 24/7 Nursing Coverage
- Independent & Supported Living Services
- OT, PT, & Speech Therapy
- Services for individuals with Autism
- Pharmacy Solutions
- Host Homes/Family Home Provider

| | | |
|--------------------------|--|--------------|
| ResCare - Evansville | 414 South Fares Ave, Evansville, IN 47714 | 812-893-1728 |
| ResCare - Ft. Wayne | 4410 Executive Blvd, Fort Wayne, IN 46808 | 260-704-0634 |
| ResCare - Indianapolis | 8041 Knue Road, Indianapolis, IN 46250 | 317-292-5832 |
| ResCare - Jeffersonville | 6200 East Hwy 62, Jeffersonville, IN 47130 | 502-523-9185 |
| ResCare - Marion | 1800 Kern Road, Marion, IN 46952 | 765-719-3437 |
| ResCare - Seymour | 357 Tanger Blvd, 215, Seymour, IN 47274 | 812-530-6242 |
| ResCare - Sheridan | 903 South Sheridan Ave, Sheridan, IN 46069 | 317-319-0332 |
| ResCare - Terre Haute | 630 North 3rd Street, Terre Haute, IN 47807 | 317-362-5462 |
| ResCare - Valparaiso | 1620 Country Club Road, Valparaiso, IN 46383 | 219-344-7110 |

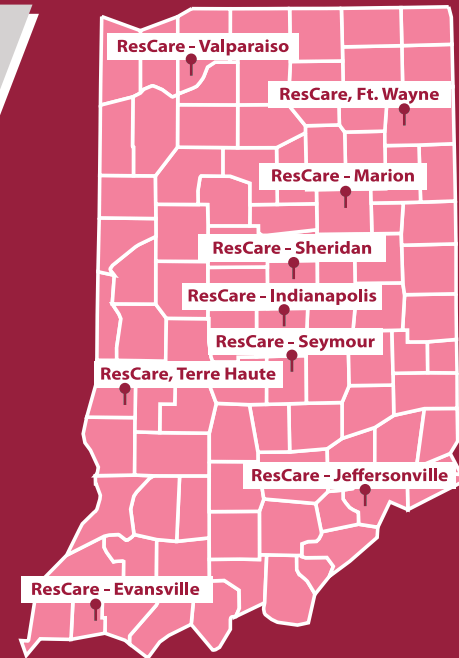

www.ResCare.com

ResCare

Belong^{ing}

MINISTRY WITH PERSONS WITH DISABILITIES

Let's build inclusive parishes
where children and adults can:



Receive sacraments



Serve



Engage in meaningful
participation



DIocese OF
FORT WAYNE-SOUTH BEND
www.diocesefwsb.org/disabilities



Fort Wayne Autism Center



Center Based ABA Therapy



Speech Therapy



Occupational Therapy



*Big Heart.
Big Focus.
Big Results.*

☎ 260-245-1455

🏠 www.fwautismcenter.com

✉ info@fwautismcenter.com



FortWayne
AUTISM CENTER



12912
Coldwater Rd



5750
Falls Drive



3948 Suite D
New Vision Dr

Floor Plan

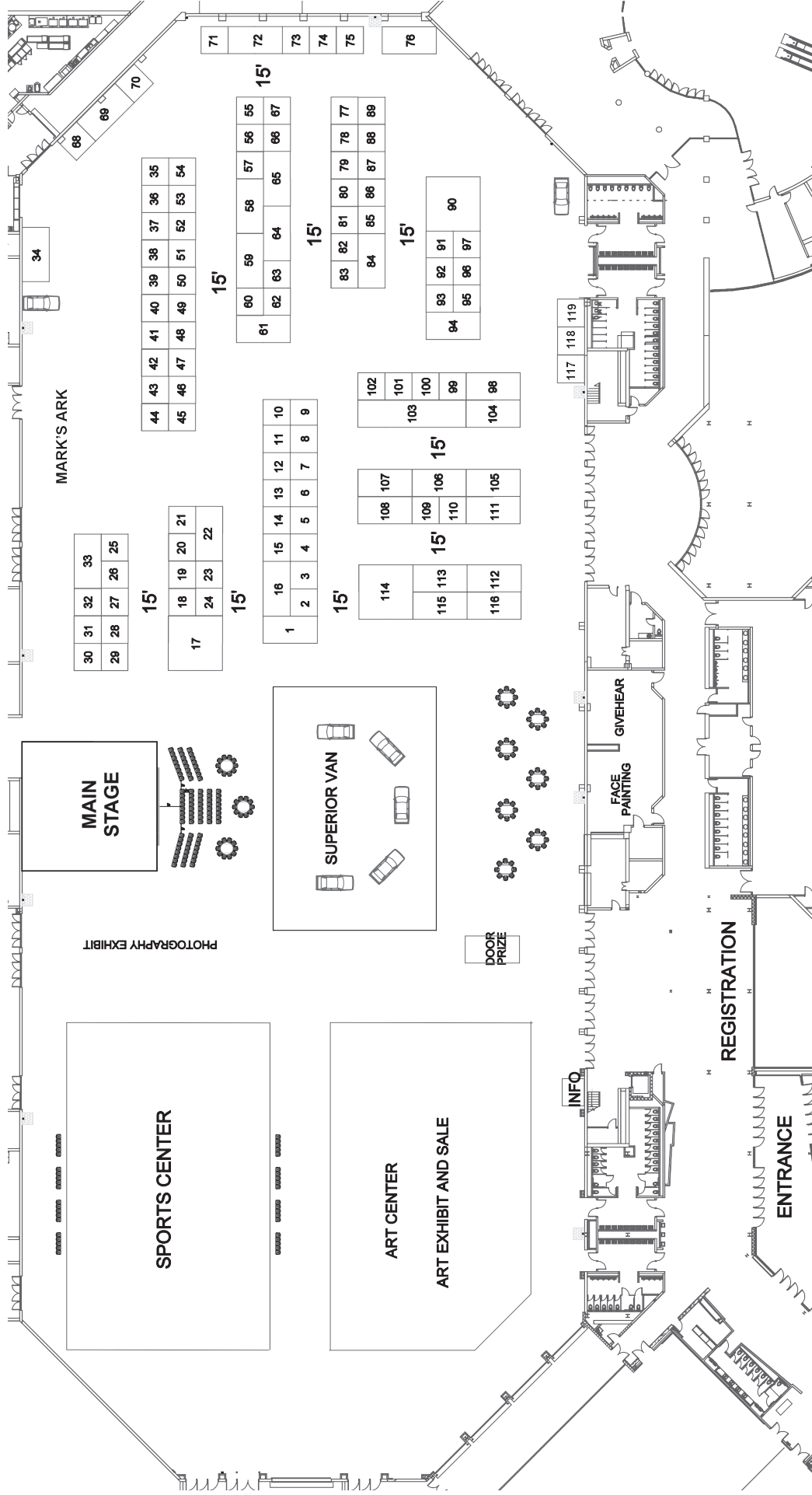

Exhibitors

Booth & Company

| | |
|--|--|
| 1A.....FINDER | 57.....CORE, The Resource Store |
| 1B.....Fort Wayne/Allen County Disability Advisory Council | 58.....YMCA of Greater Fort Wayne |
| 2.....IN*Source | 59.....PQCTrains/ Windrose Urban Farm |
| 3.....Family Voices Indiana | 60.....Employment First Fort Wayne |
| 4.....Advocacy Links, LLC | 61.....Greater Fort Wayne Inc. |
| 5.....Agape Respite Care Inc. | 62.....Aktion Club |
| 6.....Healthier Moms and Babies | 63.....I CAN Team - Volunteer Center |
| 7.....INvestable Indiana | 64.....Fort Wayne Metropolitan Human Relations Commission |
| 8.....Forbes Disability Group | 65.....Numotion |
| 9.....L.I.F.E. Adult Day Academy | 66.....Mizpah Shrine |
| 10.....Indiana Adoption Program | 67.....Mobility & Access |
| 11.....Spectrum 23.9 Online Radio | 68.....ICAN & Paytons Place |
| 12.....GiGi's Playhouse | 69.....Partners in Autism |
| 13.....ADA-Indiana | 70.....PK and Sons Enterprises |
| 14.....Down Syndrome Association of Northeast Indiana (DSANI) | 71.....F.L.O.W. Recreation LLC |
| 15.....The Arc of Indiana | 72.....Hand in Hand Comprehensive Therapy Specialists |
| 16.....IPMG | 73.....Lutheran Hospital Outpatient Rehab |
| 17.....National Seating & Mobility | 74.....Passages, Inc. |
| 18.....Fort Wayne Chapter, Indiana Association of Workers for the Blind | 75.....Canine Companions for Independence |
| 19.....Foundation Fighting Blindness | 76.....Bath Fitter |
| 20.....Writing by Gloria | 77.....Endless Abilities, Inc. |
| 21.....Ivy Tech Community College | 78.....Prevail Prosthetics & Orthotics |
| 22.....Easterseals Arc of Northeast Indiana | 79.....One Heart Disability Ministry |
| 23.....Fort Wayne Amputee Support Group | 80.....ABLE Huntington University |
| 24.....Turnstone | 81.....FW Parks & Recreation Dept. Community Center |
| 25.....Purdue University Fort Wayne - Bridges to Education and Careers Program | 82.....University of Saint Francis Jesters |
| 26.....Visually Impaired Preschool Services (VIPS) | 83.....The League |
| 27.....Indiana Mentor | 84.....Ministry with Persons with Disabilities, Diocese of Fort Wayne - South Bend |
| 28.....A Rosie Place | 85.....Camp Red Cedar |
| 29.....Fort Wayne Dance Collective | 86.....X-Ability |
| 30.....Community Transportation Network (CTN) | 87.....National MS Society |
| 31.....Community Choirs of Huntington County | 88.....Camp Millhouse |
| 32.....Humana | 89.....Autism Society of Indiana |
| 33.....Forte Residential, Inc. and Forte Home Health Care, Inc. | 90.....AutoFarm Mobility |
| 34.....Midwest Transit Equipment | 91.....Camp PossAbility |
| 35.....Center for Life Transitions | 92.....Muscular Dystrophy Family Foundation (MDFA) |
| 36.....BAYADA Pediatrics | 93.....CASS Housing |
| 37.....Compass Residential and Consulting, LLC | 94.....LEL Home Services |
| 38.....Maple Seed Farms, Inc. | 95.....Mustard Seed Furniture Bank of Fort Wayne, Inc. |
| 39.....SIMPLE MEDS PHARMACY | 96.....Children's Autism Center |
| 40.....Briezy's Bunch | 97.....LeafFilter Gutter Protection |
| 41.....Mental Health America of Northeast Indiana | 98.....Fort Wayne Autism Center |
| 42.....The MINDCAP Center | 99.....Bridges of Indiana |
| 43.....University of Saint Francis - Division of Psychology & Counseling | 100...Aging & In-Home Services of Northeast Indiana |
| 44.....Red Shoes Rock: Raising Awareness & Supporting Individuals with FASD | 101...Sky Point Social Services, LLC |
| 45.....Goodwill Industries of Northeast Indiana, Inc. | 102...Summit Equestrian Center |
| 46.....Walgreens | 103...Pathfinder Services |
| 47.....Erskine Green Training Institute | 104...Pure Abilities Recreational Therapy |
| 48.....Meridian Health Services | 105...Visiting Nurse |
| 49.....Blue Jacket Inc. | 106...AID Residential Services |
| 50.....Lowe's | 107...Kelsey Chiropractic and Neurofeedback LLC |
| 51.....Bureau of Developmental Disability Services | 108...Fresh New Start, LLC |
| 52.....Park Center | 109...Daniel's Place, Inc |
| 53.....Kroger | 110...Rescare |
| 54.....Indiana Works (WIPA Project) | 111...UniqueHab Solutions LLC |
| 55.....Walmart | 112...Byron Health Center |
| 56.....Vocational Rehabilitation Services | 113...Center for Life Transitions |
| | 114...Anthem Blue Cross & Blue Shield |
| | 115...L.I.F.E Inc. |
| | 116...Allen County Public Library |
| | 117...Convaid/R82 |
| | 118...New Wave Behavior Management |
| | 119...Beloved Shepherd LLC |
| | Face Painting.....Face Painting |
| | GiveHear.....GiveHear |
| | Main Floor.....Superior Van and Mobility |
| | Mark's Ark.....Mark's Ark |

Alphabetical Listing

| | |
|---|----------|
| A Rosie Place..... | 28 |
| ABLE Huntington University..... | 80 |
| ADA-Indiana..... | 13 |
| Advocacy Links, LLC..... | 4 |
| Agape Respite Care Inc..... | 5 |
| Aging & In-Home Services of Northeast Indiana, Inc..... | 100 |
| AID Residential Services..... | 106 |
| Aktion Club..... | 62 |
| Allen County Public Library..... | 116 |
| Anthem Blue Cross & Blue Shield..... | 114 |
| APM Medical Supplies..... | 107 |
| Autism Society of Indiana..... | 89 |
| AutoFarm Mobility..... | 90 |
| Bath Fitter..... | 76 |
| BAYADA Pediatrics..... | 36 |
| Beloved Shepherd LLC..... | 119 |
| Blue Jacket, Inc..... | 49 |
| Bridges of Indiana..... | 99 |
| Briezy's Bunch..... | 40 |
| Bureau of Developmental Disabilities Services..... | 51 |
| Byron Health Center..... | 113 |
| Camp Millhouse..... | 88 |
| Camp PossAbility..... | 91 |
| Camp Red Cedar..... | 85 |
| Canine Companions for Independence..... | 75 |
| CASS Housing..... | 93 |
| Center for Life Transitions..... | 35 |
| Children's Autism Center, Inc..... | 96 |
| Community Choirs of Huntington County..... | 31 |
| Community Transportation Network (CTN)..... | 30 |
| Compass Residential and Consulting, LLC..... | 37 |
| Convaid/R82..... | 117 |
| CORE, The Resource Store..... | 57 |
| Daniel's Place, Inc..... | 110 |
| Down Syndrome Association of Northeast Indiana (DSANI)..... | 14 |
| Easterseals Arc of Northeast Indiana..... | 22 |
| Employment First Fort Wayne..... | 60 |
| EndlessAbilities..... | 77 |
| Erskine Green Training Institute..... | 47 |
| Family Voices Indiana..... | 3 |
| FINDER..... | 1A |
| F.L.O.W. Recreation LLC..... | 71 |
| Forbes Disability Group..... | 8 |
| Fort Wayne Amputee Support Group..... | 23 |
| Fort Wayne Autism Center..... | 98 |
| Fort Wayne Chapter, Indiana Association of Workers for the Blind..... | 18 |
| Fort Wayne Dance Collective..... | 29 |
| Fort Wayne Metropolitan Human Relations Commission..... | 64 |
| Fort Wayne/Allen County Disability Advisory Council..... | 1B |
| Forte Residential, Inc. - Forte Home Health Care, Inc..... | 33 |
| Foundation Fighting Blindness..... | 19 |
| Fresh New Start, LLC..... | 109 |
| FW Parks and Recreation Dept. Community Center..... | 81 |
| GiGi's Playhouse..... | 12 |
| GiveHear..... | GiveHear |
| Goodwill Industries of Northeast Indiana, Inc..... | 45 |
| Greater Fort Wayne Inc..... | 61 |
| Hand in Hand Comprehensive Therapy Specialists..... | 72 |
| Healthier Moms and Babies..... | 6 |
| Humana..... | 32 |
| I Can Team - Volunteer Center..... | 63 |
| ICAN & Paytons Place..... | 68 |
| IN*Source..... | 2 |
| Indiana Adoption Program..... | 10 |

| | |
|---|------------|
| Indiana MENTOR..... | 27 |
| Indiana Works(WIPA Project)..... | 54 |
| Invest ABLE Indiana..... | 7 |
| IPMG..... | 16 |
| Ivy Tech Community College..... | 21 |
| Kelsey Chiropractic and Neurofeedback LLC..... | 108 |
| Kroger..... | 53 |
| L.I.F.E. Inc..... | 115 |
| L.I.F.E. Adult Day Academy..... | 9 |
| LeafFilter Gutter Protection..... | 97 |
| LEL Home Services..... | 94 |
| Lowes..... | 50 |
| Lutheran Outpatient Rehabilitation..... | 70 |
| Maple Seed Farms, Inc..... | 38 |
| Mark's Ark..... | MARK'S ARK |
| Mental Health America of Northeast Indiana..... | 41 |
| Meridian Health Services..... | 48 |
| Midwest Transit Equipment..... | 34 |
| Ministry with Persons with Disabilities, Diocese of Fort Wayne - South Bend..... | 84 |
| Mizpah Shrine..... | 66 |
| Mobility & Access..... | 67 |
| Muscular Dystrophy Family Foundation (MDFA)..... | 92 |
| Mustard Seed Furniture Bank of Fort Wayne, Inc..... | 95 |
| National MS Society..... | 87 |
| National Seating & Mobility..... | 17 |
| New Wave Behavior Management..... | 118 |
| Numotion..... | 65 |
| One Heart Disability Ministry..... | 79 |
| Park Center..... | 52 |
| Partners in Autism..... | 69 |
| Passages, Inc..... | 74 |
| Pathfinder Services..... | 103 |
| PK and Son's Enterprises Inc..... | 70 |
| PQCTrains/Windrose Urban Farm..... | 59 |
| Prevail Prosthetics & Orthotics..... | 78 |
| Purdue University Fort Wayne - Bridges to Education and Careers Program..... | 25 |
| Pure Abilities Recreational Therapy..... | 104 |
| Red Shoes Rock: Raising Awareness & Supporting Individuals with FASD..... | 44 |
| ResCare..... | 111 |
| SIMPLE MEDS PHARMACY..... | 39 |
| Sky Point Social Services, LLC..... | 101 |
| Spectrum 23.9 Online Radio..... | 11 |
| Summit Equestrian Center..... | 102 |
| Superior Van and Mobility..... | Main Floor |
| The Arc of Indiana..... | 15 |
| The League..... | 83 |
| The MINDCAP Center..... | 42 |
| Turnstone..... | 24 |
| UniqueHab Solutions LLC..... | 112 |
| University of Saint Francis - Division of Psychology & Counseling..... | 43 |
| University of Saint Francis Jesters..... | 82 |
| Visiting Nurse..... | 105 |
| Visually Impaired Preschool Services (VIPS)..... | 26 |
| Vocational Rehab Services..... | 56 |
| Walgreens..... | 46 |
| Walmart..... | 55 |
| Writing by Gloria..... | 25 |
| X-Ability..... | 86 |
| YMCA of Greater Fort Wayne..... | 76 |

Exhibitors Information

A Rosie Place
53131 Quince Rd.
South Bend, IN 46628
574-235-8899
arosieplace.org

ABLE Huntington University
2303 College Ave.
Huntington, IN 46750
260-359-4106
huntington.edu/able-program

ADA - Indiana
1905 N Range Rd.
Bloomington, IN 47408
812-855-6508
adaindiana.org

Advocacy Links, LLC
56159 Riverdale Dr.
Elkhart, IN 46514
888-537-5733
advocacy-links.com

Agape Respite Care, Inc.
298 Emmental Dr.
Berne, IN 46711
260-589-3351
agaperespite.org

Aging & In-Home Services of
Northeast Indiana, Inc.
2927 Lake Ave
Fort Wayne, IN 46805
260-745-1200
agingihs.org

AID Residential Services
1004 Woodland Plaza Run
Fort Wayne, IN 46825
260-444-3433
aidofindiana.com

Aktion Club
jeffrey.scherer16@gmail.com

Anthem Blue Cross & Blue Shield
220 Virginia Ave.
Indianapolis, IN 46204
317-287-6534
anthem.com/inmedicaid

Allen County Public Library
900 Library Plaza
Fort Wayne, IN 46802
260-421-1200
acpl.info

APM Medical Supplies
33 Tennis Village Dr.
Rockwall, TX 75032
1-844-743-7373
facebook.com/pg/apmmmedical

Autism Society of Indiana
127 Airport North Office Park
Fort Wayne, IN 46825
1-800-609-8449
autismsocietyofindiana.org

AutoFarm Mobility
810 W Mill St.
Middletown, IN 47356
765-354-2261
autofarmmobility.com

Bath Fitter
2202 Research Dr.
Fort Wayne, IN 46808
567-204-2464
bathfitter.com

BAYADA Pediatrics
6351 Constitution Dr.
Fort Wayne, IN 46804
260-432-2920
bayada.com

Beloved Shepherd LLC
3635 Lake Ave.
Fort Wayne, IN 46805
260-422-9243
belovedshepherd.com

Blue Jacket Inc.
2826 S Calhoun St.
Fort Wayne, IN 46807
260-744-1900
bluejacketinc.org

Bridges of Indiana
4011 W Jefferson Blvd., Suite 250
Fort Wayne, IN 46804
765-808-5768
bridgesofindiana.com

Briezy's Bunch
11715 Fox Rd., Ste. 400-145
Indianapolis, IN 46236
213-597-0111
briezysbunch.org

Bureau of Developmental Disabilities
Bureau of Rehabilitation Services
201 E Rudisill Blvd., Ste. 300
Fort Wayne, IN 46806
260-423-2571
in.gov/fssa

Byron Health Center
12101 Lima Rd.
Fort Wayne, IN 46818
260-637-3166
byronhealth.org

Camp Millhouse
25600 Kelly Rd.
South Bend, IN 46614
574-233-2202
campmillhouse.org

Camp PossAbility
1221 Oak Trail Ct.
Fort Wayne, IN 46845
260-341-5732
camppossability.org

Camp Red Cedar
3900 Hursh Rd.
Fort Wayne, IN 46845
260-637-3608
campredcedar.com

Canine Companions
for Independence
6607 Fenway St.
Pittsboro, IN 46167
740-833-3702
cci.org

CASS Housing
111 W Berry St., Suite 211
Fort Wayne, IN 46802
260-376-2262
casshousing.org

Center for Life Transitions
2324 Lake Ave.
Fort Wayne, IN 46805
260-201-1900
centerconnections.com

Children's Autism Center
10313 Aboite Center Rd.
Fort Wayne, IN 46804
260-459-6040
childrensautismcenter.org

Exhibitors Information

Community Choirs of Huntington County
PO Box 293
Huntington, IN 46750
765-652-4800
childrenschoirofhuntingtoncounty.org

Community Transportation Network (CTN)
5601 Industrial Rd.
Fort Wayne, IN 46825
260-420-3280
ridectn.org

Compass Residential and Consulting, LLC
9660 Commerce Dr.
Carmel, IN 46032
317-771-3184
compassrc.com

Convaid/R82
2830 California St.
Torrance, CA 90503
310-755-7826
convaid.com

CORE, The Resource Store
841 Northcrest Shopping Center
Fort Wayne, IN 46805
260-438-2673
coretheresourcestore.org

Daniel's Place, Inc.
113 W Main St.
North Manchester, IN 46962
260-306-5451
daniels-place.org

Down Syndrome Association of Northeast
Indiana(DSANI)
3320 N. Clinton
Fort Wayne, IN 46805
260-471-9964
dsani.org

Easterseals Arc of Northeast Indiana
4919 Coldwater Rd.
Fort Wayne, IN 46825
260-456-4534
eastersealsarcnein.org

Endless Abilities
6501 Constitution Dr.
Fort Wayne, IN 46804
260-436-7066
endlessabilities.net

Erskine Green Training Institute
601 S High St.
Muncie, IN 47305
765-381-8076
egti.org

F.L.O.W. Recreation LLC
303 Stable Dr.
Fort Wayne, IN 46825
330-979-9576
flowrectherapy.com

Family Voices Indiana
12175 Visionary Way, St. 1360
Fishers, IN 46038
317-374-7857
fvindiana.org

FINDER
8515 Bluffton Rd.
Fort Wayne, IN 46809
260-207-5728
IndianaDisabilityResourceFINDER.org

Forbes Disability Group
312 North Wayne St., PO Box 374
Angola, IN 46703
260-319-0515
needsocialsecurity.com

Fort Wayne Amputee Support Group
3320 N Clinton St.
Fort Wayne, IN 46805
260-431-7290
facebook.com/fwamputeesupportgroup

Fort Wayne Autism Center
12912 Coldwater Rd., Ste. E
Fort Wayne, IN 46845
260-245-1455
FWAutismCenter.com

Fort Wayne Chapter - Indiana Association of
Workers for the Blind
1730 Colony Dr.
Fort Wayne, IN 46825
260-438-9216
workersfortheblind.org

Fort Wayne Dance Collective
437 E Berry St.
Fort Wayne, IN 46802
260-424-6574
fwdc.org

Fort Wayne Metropolitan Human
Relations Commission
2310 Parnell Ave.
Fort Wayne, IN 46805
260-427-1146
fortwaynemetrol.org

Forte Residential, Inc.
Forte Home Health Care, Inc.
120 S Lake St., Suite 100
Warsaw, IN 46580
574-549-9961
forteresidential.org

Foundation Fighting Blindness
977 Lakeview Pkwy.
Vernon Hills, IL 60061
847-680-1136
fightblindness.org/fortwaynevisionwalk

Fresh New Start
1625 Morningstar Blvd.
Decatur, IN 46733
260-724-2511
freshnewstart.net

FW Park and Recreation
Community Center
233 W Main St.
Fort Wayne, IN 46802
260-427-6465
fortwayneparks.org

GiGi's Playhouse Fort Wayne
6081 North Clinton St
Fort Wayne, IN 46825
260-482-7529
gigisplayhouse.org/fortwayne

GiveHear
130 W Main St., Ste. 150
Fort Wayne, IN 46802
260-602-3276
givehear.org

Goodwill Industries of Northeast
Indiana, Inc.
1516 Magnavox Way
Fort Wayne, IN 46804
260-478-7617
fwgoodwill.org

Greater Fort Wayne Inc.
200 E Main St., Ste. 800
Fort Wayne, IN 46802
greaterfortwayneinc.com

Hand In Hand
Comprehensive Therapy Specialists
9426 Lima Rd., Suite A
Fort Wayne, In 46818
260-497-0328
handinhandtherapy.com

Humana
7035 E 96th St., Ste. F
Indianapolis, IN 46250
317-558-5675
humana.com

I CAN Team - Volunteer Center
3401 Lake Ave., Suite 4
Fort Wayne, IN 46805
260-424-3505
volunteercenterfortwayne.org

ICAN & Paytons Place
409 E Cook Rd., Ste. 100
Fort Wayne, IN 46825
260-487-4226
ican-autism.com

IN*SOURCE
1703 South Ironwood Dr.
South Bend, IN 46613
574-234-7101
insource.org

Indiana Adoption Program
1575 Doctor M.L.K. Jr. St., Ste. 100
Indianapolis, IN 46202
1-855-677-5437
adoptachild.in.gov

Indiana MENTOR
6008 Brandy Chase Cove
Fort Wayne, IN 46815
260-485-5899
in-mentor.com

Indiana Works (WIPA Project)
2020 Brown St.
Anderson, IN 46016
765-641-8382
aspireindiana.org/indiana-works-wipa/

Invest ABLE Indiana
One North Capitol, Ste. 900
Indianapolis, IN 46204
317-232-1614
in.savewithable.com

IPMG
1305 Cumberland Ave., Ste. 110
West Lafayette, IN 47906
1-866-672-4764
gotoipmg.com

Ivy Tech Community College
3701 Dean Dr.
Fort Wayne, IN 46835
260-480-4110
ivytech.edu

Kelsey Chiropractic and Neurofeedback LLC
10910 US Hwy 24 W Unit A
Fort Wayne, IN 46814
260-432-8777
fwneurofeedback.com

Kroger
4120 N Clinton St.
Fort Wayne, IN 46805
260-473-3467
jobs.kroger.com

L.I.F.E. Inc.
5202 Flagstaff Cove
Fort Wayne, IN 46815
260-489-7070
lifeinresidential.com

BATH FITTER®

The Bath Fitter Difference



Lifetime Warranty for as long as you own your home



Seamless walls



Installation in as little as one day



Bath Fitter-trained team of experts

When your bathtub days are over,
convert to an extra-large,
easy access shower!

Call to set up your **free** in-home consultation today!

260-222-2259

Locally owned & operated! | 2202 Research Drive, Fort Wayne, IN 46808



AFTER



BEFORE



LEADING PURPOSE-FILLED LIVES

Byron Wellness Community provides exceptional medical care to meet the needs of individuals who have complex medical conditions, most often coupled with psychiatric or developmental disorders.

For more information,
call or visit us online

260-637-3166
www.ByronHealth.org

12101 Lima Road
Fort Wayne, IN 46818
info@ByronHealth.org



LEADING PURPOSE-FILLED LIVES

INCLUSION • ACCEPTANCE • COMPASSION • ENCOURAGEMENT



"INCLUSION WITHOUT EXPLANATION"

WHO WE SERVE

* Medicaid Waiver participants in search of integrated and community supports.

* The Waivers we provide supports for include: CIH (Community Integration and Habilitation), FSW (Family Supports Wavier), A&D (Aged & Disabled) and TBI (Traumatic Brain Injury), Caregiver Support

SERVICES WE OFFER

RHS
CHIO
Respite
SFC
PAC

Recreational Therapy
Music Therapy
Behavior Management
Attendant Care
Homemaker Services



New and Pre-Owned Mobility Vehicles

- Sales and Service
- Competitive Financing Available
- Great Selection of Inventory



CALL OR EMAIL SCOTT GIBSON AT
scott.gibson@midwesttransit.com
(708) 269-1894



9 Locations Throughout
IL, IN, MI, MO, and KS

midwesttransit.com
(800) 933-2412



SPECIAL ABILITIES DAY

- Sunday, June 23
- Saturday, Aug. 17
- Tuesday, Sept. 24*
- Saturday, Nov. 9
- Tuesday, Dec. 10*

*closed to the public

With special thanks to
the AWS Foundation



More information & registration at
sciencecentral.org!

Do You Have Questions About HOSPICE?

Contact Visiting Nurse Today

260-435-3222
800-288-4111
www.vnfw.org

- Palliative Care
- Hospice Care
- Hospice Home
- Grief Support



Visiting Nurse



CELEBRATE ABILITIES

YMCA OF GREATER
FORT WAYNE

fwymca.org

Contact Director of Adaptive Services
Rebekah_Coffey@fwymca.org
260.755.4961

Exhibitors Information

L.I.F.E. Adult Day Academy
7515 Westfield Dr.
Fort Wayne, IN 46825
260-436-5232
ladafw.com

LeafFilter Gutter Protection
1595 Georgetown Rd.
Hudson, OH 44236
1-800-726-7703
leafilter.com

LEL Home Services
5555 W 72nd St.
Indianapolis, IN 46268
317-387-1443
lelhs.com

Lutheran Hospital Outpatient Rehab
7950 W. Jefferson Blvd.
Fort Wayne, IN 46804
260-435-6143
lutheranhealth.net

Maple Seed Farms, Inc.
101 W Dupont Rd.
Fort Wayne, IN 46765
260-415-8189
mapleseedfarms.org

Mental Health America of Northeast Indiana
1027 W Rudisill Blvd.
Fort Wayne, IN 46807
260-422-6441
mhanortheastindiana.org

Meridian Health Services
4646 W Jefferson Blvd., Ste. 100
Fort Wayne, IN 46804
260-436-0932
meridianhs.org

Midwest Transit Equipment
146 W Issert Dr.
Kankakee, IL 60901
815-933-2412
midwesttransit.com

Ministry for Persons with Disabilities
Diocese of Fort Wayne - South Bend
915 S Clinton St.
Fort Wayne, IN 46802
260-399-1458
diocesefwswb.org/disabilities

Mizpah Shrine
1015 Memorial Way
Fort Wayne, IN 46805
260-426-4543
mizpahshrine.com

Mobility & Access
1003 International Dr.
Oakdale, PA 15071
412-996-6769
mobilityaccess.com

Muscular Dystrophy Family Foundation (MDFA)
PO Box 776
Carmel, IN 46032
317-615-9140
maff.org

Mustard Seed Furniture Bank of Fort Wayne, Inc.
3636 Illinois Rd.
Fort Wayne, IN 46804
260-471-5802
mustardseedfortwayne.com

National MS Society
3500 DePauw Blvd., Suite 1040
Indianapolis, IN 46268
317-870-2500
nationalMSsociety.org

National Seating & Mobility, Inc.
510 Incentive Dr.
Fort Wayne, IN 46825
260-489-5200
nsm-seating.com

New Wave Behavior Management
2920 Farnsworth Dr.
Fort Wayne, IN 46805
765-207-0020
info@newwavebman.com

Numotion
1901 Production Rd.
Fort Wayne, IN 46808
317-331-7979
Numotion.com

One Heart Disability Ministry
1400 W. Washington Center Rd.
Fort Wayne, IN 46825
260-338-6608
oneheartdisabilityministries.org

Park Center, Inc.
909 E State Blvd.
Fort Wayne, IN 46805
260-969-8464
parkcenter.org

Partners in Autism
3030 Lake Ave., Suite 20
Fort Wayne, IN 46805
260-420-9332
partnersinautism.com

Passages, Inc
301 W. Van Buren St.
Columbia City, IN 46725
260-609-8342
passagesinc.org

Pathfinder Services
2824 Theater Ave.
Huntington, IN 46750
260-356-0500
pathfinderservices.org

PK and Son's Enterprises Inc.
8104 Pepperwood Ct.
Fort Wayne, IN 46818
260-414-8148
pkandsonsinc.com

PQCTrains/Windrose Urban Farm
4211 Hobson Court, Ste. A
Fort Wayne, IN 46815
260-420-7374
pqctrains.com

Prevail Prosthetics & Orthotics
7735 West Jefferson Blvd., Ste. C
Fort Wayne, IN 46804
260-483-5219
prevailpando.com

Purdue University Fort Wayne - Bridges to Education and Careers
2101 E Coliseum Blvd.,
Walb Student Union, Room 111
Fort Wayne, IN 46805
260-481-6592
pfw.edu/bridges

Pure Abilities Recreational Therapy
6353 Constitution Dr.
Fort Wayne, IN 46804
330-441-2258
pureabilities.com

Red Shoes Rock: Raising Awareness & Supporting Individuals with FASD
4424 Thorngate Dr.
Fort Wayne, IN 46835
260-486-8997
redshoesrock.com

ResCare
4410 Executive Blvd.
Fort Wayne, IN 46808
260-705-2531
rescare.com

Simple Meds
6862 Hillsdale Ct.
Indianapolis, IN 47250
317-558-8787
simplemeds.com

Spectrum 23.9 Online Radio
2309 Longleaf Dr.
Fort Wayne, IN 46814
260-402-7591
thespectrum239.com

Summit Equestrian Center
10808 LaCabreah Ln.
Fort Wayne, IN 46845
260-619-2700
summitequestrian.org

Superior Van & Mobility
2218 Contractor's Dr.
Fort Wayne, IN 46818
260-494-1431
superiorvan.com

The Arc of Indiana
143 W Market St., Ste. 200
Indianapolis, IN 46204
317-977-2375
arcind.org

The League
5821 S. Anthony Blvd.
Fort Wayne, IN 46816
260-441-0551
the-league.org

The MINDCAP Center
6507 Constitution Dr.
Fort Wayne, IN 46804
260-703-3363
mind-cap.org

Turnstone
3320 N. Clinton St.
Fort Wayne, IN 46805
260-969-7630
turnstone.org

UniqeHab Solutions LLC
5508 St. Joe Rd.
Fort Wayne, IN 46835
260-705-2728
uniquehab.com

University of Saint Francis - Division of Psychology & Counseling
2701 Spring St.
Fort Wayne, IN 46808
260-399-7700
sf.edu

University of Saint Francis Jesters
2701 Spring St.
Fort Wayne, IN 46808
260-745-3107
sf.edu

Visiting Nurse
5910 Homestead Rd.
Fort Wayne, IN 46814
260-435-3222
vnfw.org

Visually Impaired Preschool Services (VIPS)
1100 W 42nd St., Ste. 228
Indianapolis, IN 46208
1-888-824-2197
vips.org

Vocational Rehabilitation Services
201 E Rudisill Blvd., Ste. 300
Fort Wayne, IN 46806
260-424-1595
in.gov/fssa/ddrs/2636.htm

Writing by Gloria
1124 Putnam St.
Fort Wayne, IN 46808
260-417-0832
writingbygloria.com

X-Ability
125 S Jeffery Ave.
Ithaca, MI 48847
989-620-6611
xabilitystore.com

YMCA of Greater Fort Wayne
347 W. Berry St., Suite 500
Fort Wayne, IN 46802
260-422-6488
fwymca.org



AID of Indiana

A.I.D. Residential Services
1004 Woodland Plaza Run
Fort Wayne, IN. 46825
260.444.3433

Assistance

Independence

Dignity

Servicing people with intellectual disabilities. We provide:
Medical Waiver (family support and Community Integration Habilitation)
Wellness Coordination (tier 1,2, & 3)
Community Integration (CHIO)
Respite (A “break” for family and caregivers)
Participant Assistant Care (PAC)

If you have any questions, please do not hesitate to call us we would love to talk to you!



Goodwill
Industries of Northeast Indiana, Inc.
260-478-7617
www.fwgoodwill.org



Accredited by the
Commission on
Accreditation of
Rehabilitation Facilities

A SINGLE SOURCE, A WORLD OF POSSIBILITIES.



Living with a disability can be a challenge. Finding service providers, programs, equipment and community advocates that can help overcome those challenges, shouldn't be. Welcome to FINDER. It's **free**, easy to use and ready to help you.

This online resource gives you 24/7 access to the community resources across Indiana that can improve your quality of life. FINDER helps you quickly and easily compile a complete list of resources, tailored just for you.

FINDER covers a wide range of disabilities and topics of interest for every stage of life, including:

| | |
|---------------------------------------|-------------------------|
| Advocacy | Healthcare |
| Basic Needs | Housing |
| Bullying | Insurance |
| Communication | Intervention |
| Education | Personal Finance |
| Employment | Recreation |
| Equipment | Respite |
| Family Support | Sexuality |
| Financial Assistance | Social Inclusion |
| Guardianship/ Alternatives | Transportation |



Funded by AWS Foundation

IndianaDisabilityResourceFINDER.org



◀ FIND answers

**FREE. Easy to use.
Ready to help you.**

IndianaDisabilityResourceFINDER.org

Seek.

Need disability and complex health-related services and supports located in your community? Use FINDER's directory of services, programs and helpful articles to FIND the answers you need.

Discover.

Take a guided journey or use the advanced search feature to enter what you're looking for and FINDER's technology will do the rest. FINDER is an online resource designed to collect and organize contact and service information from providers across Indiana.

Connect.

Learn about and connect with service providers, professionals and organizations that can help improve quality of life. Designed to help you locate options to make an informed decision that is best for your unique situation, FINDER does not endorse or promote programs, services, or providers.

Inform.

In addition to its existing content, IndianaDisabilityResourceFINDER.org is designed to give everyone the opportunity to submit new information and report changes needed to an existing listing that may benefit others. All of the information and resources shared are reviewed, verified and approved before they are published to ensure their accuracy and value. Promoting collaboration and sharing user feedback supports inclusion of opportunities and resources of all sizes and types from every community state-wide.

Questions? The best way to contact FINDER is by e-mail at Info@IndianaDisabilityResourceFINDER.org. If you would like to speak with a team member, be sure to ask for a return call and provide a phone number along with the best time to reach you.



PQC **Trains**

- Vocational Rehabilitation
- Pre-employment Training
- Ticket To Work
- BIN Certified

**Empowering People
To Live Well!**

4211 Hobson Court Fort Wayne, IN 260.420.7374 www.pqctrains.com ebrady@pqcworks.com

Serving Hoosier Healthwise,
Healthy Indiana Plan and
Hoosier Care Connect



Working together for better health

**Anthem Blue Cross and Blue Shield —
your choice for a healthy life.**

Visit us at www.anthem.com/inmedicaid.



Anthem Blue Cross and Blue Shield is the trade name of Anthem Insurance Companies, Inc., independent licensee of the Blue Cross and Blue Shield Association. Anthem is a registered trademark of Anthem Insurance Companies, Inc.

EMPLOYING PEOPLE WITH
DISABILITIES
INITIATIVE

OPENING PATHWAYS TO EMPLOYMENT

MEET US AT BOOTH 61

disabilities.gfwinc.com



**GREATER
FORT WAYNE INC.**
METRO CHAMBER ALLIANCE