



Disabilities EXPO

Discovering possibilities. Celebrating differences.

Show Directory and Program Guide

Hosted by:

May 13, 2023 10am - 3pm

Allen County Memorial Coliseum



Could a Wheelchair-Accessible Vehicle or Lift **HELP YOU** Gain Added Mobility?



Wheelchair Van Rentals

1-844-648-RENT

Try Before You Buy!

Great rates - Daily / Weekly / Monthly!

**Wheelchair-Accessible
Van & SUV Conversions**
- New & Pre-owned -



**Wheelchair and
Scooter Lifts**



**Mobility
Seating**

Superior[®]
Van & Mobility



Making Mobility Possible!

Consumer / Commercial
SALES - SERVICE - RENTALS

2218 Contractors Drive, Fort Wayne

(260) 497-VANS (8267)

For all your mobility
transportation needs 24/7...

www.SUPERIORVAN.com

WELCOME

Welcome to the 12th annual Disabilities Expo! We are so happy to bring this event back after two years of off.

This day has been planned just for you with more than 120 exhibitors to make this a one-stop resource for all types of disability services and products. We hope that you find what you need, and even more importantly, discover new

resources to enhance your quality of life. The Expo is also filled with fun and entertaining events, spectacular adaptive sports exhibitions and special guests making a difference in the disability world.

Helping you explore opportunities, expand possibilities and experience everything is what the Disabilities Expo is all about. Spend a few hours or the entire day...we're glad you are here!

You will notice that our logo has changed! We have decided that our previous logo and branding showcased outdated ideas. The lowercase 'dis' with all uppercase 'ABILITIES,' while harmless, missed the mark of our intended message. The Disabilities Expo is more than sharing resources; it is a celebration of people with disabilities in our community.



PLANNING COMMITTEE

Andie Mosley
AWS Foundation

Ashley Gettys
Easterseals Arc

Candy Pease
Positive Pathways

Jamie Mann
Pathfinder Services

Julie Weingartner
Parent, Turnstone

Karlie Coker
Aging and In-Home Services

Kathy Morse
Leisure for Life

LaToya Allen
Voc Rehab Services

Laura Lindsay
The League

Marcia Carter
Rec Therapy Professor

Randy Wolf
Goodwill

Tina Acosta
Turnstone

Tom Steigmeyer
WLDE 101.7/WAJI 95.1

Tommy Guest
Partners in Autism

Traci Garman
Superior Van & Mobility

Scott Thornsberry
Pathfinder Services

AWS Foundation is pleased to host the 2023 Disabilities Expo, the only event of its kind in the tri-state area. Our mission is to help children and adults with enduring intellectual, developmental, and physical disabilities live as independently as possible, be included in the community and function at their highest potential. Since our grant making began in 2009, the Foundation has awarded grants totaling over \$38 million to more than 185 northeast Indiana organizations working with individuals with disabilities and their families.

We extend a very special thanks to these sponsors and partners:

Inclusion and Main Stage Sponsor

Superior Van and Mobility
Partners in Autism
Indiana Disability Resource FINDER

Event Sponsors

George's Pharmacy
Greater Fort Wayne
Meridian Health Services
New Wave Wellness
PQC Trains
ResCare Community Living
YMCA of Greater Fort Wayne

Expo Hall Sponsors

A.I.D. Residential Services
Anthem, Inc.
Easterseals Arc of Northeast Indiana
Fletcher Van Gilder, Attorneys at Law
INvestABLE Indiana
Mobility Plus Columbia City
Pathfinder Services

Activities Sponsors

Agape Mobility Ethiopia
Allen County Public Library
Forte Residential & Forte Home Health
Goodwill
Humana
Indiana Professional Management Group (IPMG)
Metropolitan Human Relations Commission
New Leaf Recreation

Positive Pathways Counseling and Consulting
PRC-Salttillo
The League
Torres Behavioral Health
True North Consulting Group
UniqueHab Solutions
YOURspace Inc.



THE Y IS FOR ALL

YMCA OF GREATER FORT WAYNE



Adaptive & Inclusive Services

The YMCA provides a variety of Adaptive and Inclusive programs. Whether you're a beginner, a seasoned athlete, or just want to have fun, come explore what we have to offer. Examples include sports, arts, camps, sensory friendly and social events for people of all ages.

To learn more or to join our mailing list, contact the Director of Adaptive Services at **260-755-4961** or visit fwymca.org/adaptive

Be part of the conversation by joining our Facebook group:
YMCA Adaptive & Inclusive Programs

SCAN QR CODE TO JOIN!



Our mission is to put Christian principles into practice through programs that build healthy spirit, mind and body for all.



Learning Experiences through Adaptive Programs

Hour-by-Hour

Main Stage

10:15am Fashion Show with Chea Clothing
11:00am Jesters Presentation
12:00pm Kendra Lee
12:30pm Sockie Phommachanh
1:00pm Fort Wayne Dane Collective
2:00pm Joyful Songsters

Sports Center

11:20am Dazzlers Cheerleading Performance
12:00pm Turnstone Power Soccer
1:00pm Turnstone Bocchia
2:15pm Turnstone Open Play

All Day Activities at the Expo

Find what you need from local, regional and national companies representing a wide range of services and products with the knowledge and resources to enhance your quality of life — for every ability at every age and stage of life.

Game Center

We have jumbo checkers, ringtoss, shuffleboard, and more! We've worked to adapt the games to your needs. Be sure to also stop at the the YMCA and Pure Abilities booths right next to the game center for even more fun!

Collaborative Art Project

Come make your mark on the Expo! We've got markers, stamps, and shapes (to trace) and adaptive tools to ensure that everyone can participate. Whether you're an artist and want to create something in your own style, or just want to sign your name, everyone is welcome.

Art Exhibit and Sale

Experience art in its various forms, styles and subject matter. It is all on display with many pieces for sale showcasing the artistic talents of individuals with disabilities in Northeast Indiana.

Photography Partnership Project Exhibit

It is said that a picture speaks 1,000 words. These images not only speak, they create emotion. The people in these exhibit photos show that individuals living with disabilities are strong, confident, successful and, most of all, happy. Portraits of individuals with disabilities, photographed by University of Saint Francis visual arts students, will capture Expo-goers' hearts.

Free Hearing Screenings

GiveHear is giving free hearing screenings all day. They are located in the alcove next to the concession stand.

Door Prizes

We've put together some great items that you have a chance to win. There's no purchase necessary, all we ask is that you fill out a survey. Good luck!

In the Art Center

Curated By:

Regional Special Arts Exhibit and Sale



Don't miss this opportunity to enjoy and shop these wonderful, artistic creations.

Photography Partnership Project Exhibit

Portraits of individuals with disabilities, photographed by University of Saint Francis visual arts students, will capture Expo-goers' hearts and provide a glimpse into what makes the subject matter so special. We express our thanks and appreciation to Professor Cara Wade and the visual art students for capturing these images.



Disabilities Expo Sticker Collection

This year we've started something new; stickers! Each year we will hire an artist with a disability to design a sticker for the Expo. It will always have "Disabilities Expo" with the year, but everything else will be up to the chosen artist. The stickers are our free gift to all of our attendees. The idea is to collect them each year to commemorate this annual celebration of disability. Check out about this year's sticker artist below:

Garrett is a 20-year-old Huntington ABLE student that loves to create. What he most likes about himself is that he is good at drawing. His favorite thing to do in the community is go out to eat with his friends, and his parents and therapist are who support him the most. Garrett works at Pizza Hut and does the dishes and sometimes makes the pizza. To him, disability means that you can't do certain things and his greatest daily challenge is trying to not worry about having a relationship.



Garrett



Guest Performances

Jesters

Founded in 1979, the University of Saint Francis Jesters provides multi-disciplinary performing arts opportunities to people with intellectual/developmental disabilities (I/DD), ages 8-senior citizens. The Jesters program features a summer exploration, a core academic year program with an original culminating performance and guest artist residencies. In 2017, the Jesters presented artists from Second City Theatre Chicago who taught workshops on improvisational skills to people with I/DD. During 2018, the Jesters has launched a new integrated improv group comprised of people with and without disabilities. This year's lecture-demonstration will feature improv games presented by people with I/DD who are part of this new performing group.

Dazzlers Cheerleading Squad

The Whitley County Dazzlers Cheerleading Squad is in their 12th season with nearly 30 team members. This year the team performed in Orlando and spent a day at Disney enjoying each other. It's fun and friendship with a little exercise thrown in for a great show of spirit.

Joyful Songsters

Joyful Songsters is a community choir open to all teens and adults with no audition required. The program is designed to provide an integrated choral experience for individuals with disabilities, senior citizens, and other teens and adults living in Huntington County. Choir members promote a sense of community involvement within their group and throughout the community while participating in high quality music learning and performance. They are currently accepting new singers with or without disabilities. Participation is free.

Kendra Lee - "This is How I Roll"

I was told that I would never amount to anything and I wouldn't be able to graduate with my brothers this went on since middle school all the way up to my senior year of high school but little did they know I would not take no for an answer I graduated with my high school diploma and now I am in college studying Human Services to become a community advocate for individuals with a disability.

The reason behind me wanting to become a community advocate for individuals with the disability it's because throughout my life I've had to fight every single day for everything I've ever gotten I know that it's exhausting trying to prove yourself every single day that you're more than your disability I want to be able to share my experiences with individuals and let them know that we are not alone.

My passion project/ my brand is roll with life I started this when I was 16 simply because my brothers had the passion for wheelchair basketball and I wanted to do something that created that same passion for myself. it's fully controlled by myself. The mission statement behind it is to empower individuals with a disability and to share awareness.

And more!

 **PQCTrains**

WWW.PQCTRAINS.COM
260-420-7374



**ENCOURAGING & EMPOWERING INDIVIDUALS
TO CULTIVATE & GROW THEIR FUTURES.**

Sports Center

Power Soccer

Power Soccer is played in power wheelchairs and is one of the most popular adaptive sports in the world. Even those with very limited physical abilities can participate and find great success. The game is played in a gymnasium on a regulation basketball court. Two teams of four players attack, defend, and spin-kick a 13-inch soccer ball. Turnstone has offered power soccer since 2006.

Athletes as young as 5 years old can participate in power soccer. Athletes' disabilities include quadriplegia, multiple sclerosis, muscular dystrophy, cerebral palsy, and others.

Turnstone offers power soccer competitively and recreationally. Competitive power soccer practices once per week at Turnstone and travels for competitions. Competitions are on weekends at home or travel to games throughout the Midwest. The power soccer season runs from September through June and culminates in a national tournament. Recreational power soccer practices and plays at Turnstone learning the fundamentals of power soccer.

United States Power Soccer Association (USPSA) is the governing body of power soccer in the United States. To find out more information or watch videos, go to the USPSA website - <https://www.powersoccerusa.org/>



Boccia

In boccia, a set of balls is thrown or rolled onto a court by opposing players, getting as close as possible to a target ball. Players can strategically knock opponents' balls away from the target ball. In adaptive boccia, a ramp can be used to propel the ball, and someone can be used to assist with lining up to ramp during games.



Participants should be at least 12 years old and have the ability to either propel a boccia ball with their hand or foot or utilize a ramp to aim and propel the ball onto the court.

Competitive boccia is open to persons described as quadriplegic with cerebral palsy, traumatic brain injury, stroke survivors, OR persons who have conditions of a non-cerebral origin that affect all four limbs (such as high spinal cord injury, muscular dystrophy, arthrogryposis, MS, or ALS). For recreational purposes, Turnstone allows individuals with other physical disabilities to qualify for this program.

While participating at Turnstone, boccia participants can expect to learn the history and rules of the game, learn the skills and techniques needed to play boccia, enjoy opportunities to play recreationally or

competitively, have opportunities to network with other people with physical disabilities, and engage in a fun and challenging sport.

Boccia is a Paralympic sport in which is trying to grow and prepare for the 2028 Los Angeles Games.

For more information or to sign up for the program, contact Kevin Hughes, Manager of Sports, at kevin@turnstone.org or (260) 483-2100 ext. 296.



Embracing differences. Empowering people.

Easterseals Arc of Northeast Indiana is committed to supporting people with disabilities and leading the way to full equity, access and inclusion.



By offering a wide range of programs and services to meet individual needs, Easterseals is:

- Enriching education
- Enhancing health
- Expanding employment
- Elevating community



Learn more about Easterseals at www.eastersealsnei.org.

Easterseals Arc
Fort Wayne

Easterseals Passages
Columbia City

Easterseals RISE
Angola

Giving Those with Disabilities the ABILITY TO SAVE

- Tax-advantaged saving without impacting your current benefits
- Savings and investment options that fit your needs
- Easily access your funds anytime

InvestABLE
INDIANA

PLAN • PROVIDE • PROSPER

LEARN MORE in.savewithable.com

To learn about InvestABLE Indiana, its investment objectives, risks and costs, carefully consider the Program Disclosure Documents available at in.savewithable.com before investing.

Check with your home state to learn if it offers tax or other benefits for investing in its own ABLÉ plan. Ascensus College Savings Recordkeeping Services, LLC is the program manager.

ALLEN COUNTY PUBLIC LIBRARY A LIBRARY FOR YOU!

AUDIO READING SERVICE

Designed for individuals of any age with visual, physical, learning, or language challenges to reading printed materials. Hear local newspapers and national publications on a variety of listening methods at no cost.

LIBRARY AT HOME

ACPL provides free delivery of library materials to homebound patrons and pop-up libraries at facilities throughout Allen County, where residents can sign up for a library card, check out materials, and more.

ALL ABILITIES CLUB

Adults with intellectual/developmental disabilities and their caregivers are invited to enjoy crafts, games, literacy activities, movies, and more. Registration is strongly recommended.



**TO LEARN MORE, PLEASE VISIT WWW.ACPL.INFO,
CALL (260) 421-1200, OR SPEAK WITH A LIBRARIAN.**

Our stories may be different, but we all have equal rights.

Are you being treated differently because of your color, race, national origin, disability, religion, gender, ancestry, age or sex?

At Metro, it's our job to enforce civil rights laws in the City of Fort Wayne. If you believe you are the victim of discrimination, contact Metro today to speak with a local investigator.

Learn about your rights!

260-427-1146
FortWayneMetro.org

SEXUAL VIOLENCE IS

**NEVER
YOUR
FAULT**

**FIND RESOURCES
NO MATTER WHAT FW.ORG**





New to Fort Wayne!

6425 Cross Creek Blvd

(260)702-9931

dme@georgespharmacy.com

DME Supplier

- Lift Chairs
- Wheelchairs
- Hospital Beds
- Bathroom Safety
- Mobility Assists

Complex Rehab Technology

- Custom Manual & Power Chairs
- Custom Seating Solutions
- Pediatric Products

Pharmacy

- WE DELIVER
- Customized Pill Packaging



Respiratory

- CPAP & BiPAP
- Home Oxygen Concentrators
- Portable Oxygen Concentrators
- Portable Oxygen Tanks

Waiver Provider- Aged and Disabled & BDDS

Looking for something specific?

We have categorized our vendors to help you find the resources you need. Many vendors fall under several categories. Once you've found the vendors that offer the product/services you need, you can use our alphabetical vendor listing to find their booth number.

ABA Therapy

Children's Autism Center
Maple Seed Farms
Partners in Autism
Sara's Garden / Special Grounds Coffee Co.
Total Care ABA

Adaptive Equipment

AutoFarm Mobility
Camp Red Cedar
Chea Clothing
Georges Pharmacy and Medical Equipment
Mizpah Shrine Center - Shriners Children's
Mobility Plus Columbia City
National Seating & Mobility
Superior Van & Mobility
The INDATA Project at Easterseals Crossroads
The League
Turnstone
VA Northern Indiana Health Care System
YMCA of Greater Fort Wayne
YOURspace

Adaptive Recreation

Advocacy Links Resource and Advocacy Center
Camp Red Cedar
DSANI (Down Syndrome Association of Northeast Indiana)
Fort Wayne Dance Collective
Fort Wayne Parks & Recreation Community Center Sensory Clubhouse
Life Adult Day Academy
Mizpah Shrine Center - Shriners Children's
Pure Abilities Therapeutic Services
Special Stars Baseball Clinic
Turnstone
VA Northern Indiana Health Care System
We Carry Kevan
YMCA of Greater Fort Wayne

Blind/Low Vision & Deaf/Hard of Hearing Services

Allen County Public Library
Camp Red Cedar
Fort Wayne Chapter, Indiana Association of Workers for the Blind
GiveHear
Indiana Talking Book and Braille Library
The League
VA Northern Indiana Health Care System
Visually Impaired Preschool Services

Counseling & Psychology/ Diagnosing Services

Meridian Health Services
Mizpah Shrine Center - Shriners Children's
Positive Pathways Counseling and Consulting
Torres Behavioral Health
Turnstone
VA Northern Indiana Health Care System

Day Programs

Camp Red Cedar
Easterseals Arc Of Northeast Indiana
Life Adult Day Academy
Maple Seed Farms
Pathfinder Services
The Arc of LaGrange County
Turnstone
VA Northern Indiana Health Care System

Disability Advocacy

Advocacy Links Resource and Advocacy Center
American Medicare Disability Advocates
Bring It Push It Own It
Camp Red Cedar
Canine Companions
Collab-Unity
DSANI (Down Syndrome Association of Northeast Indiana)
Easterseals Arc Of Northeast Indiana
Fletcher Van Gilder, Attorneys at Law
Fort Wayne/Allen County Disability Council
IN*SOURCE
Indiana Family to Family
Indiana University Skills on Wheels
Learn From Autistic People
Life Adult Day Academy
Metropolitan Human Relations Commission
Mizpah Shrine Center - Shriners Children's
Pathfinder Services
PQCTRANS
Sensory Awareness Education & Outreach
The Arc of Indiana
The Arc of LaGrange County
The League
Turnstone
VA Northern Indiana Health Care System



NEW WAVE WELLNESS

Hope in Motion



Melissa Fisher, MS/MDiv
Owner/Operator



Erica Pearson, MS
Owner/Operator

Who We Are

New Wave Wellness is owned and operated by Erica Pearson and Melissa Fisher. Erica and Melissa have over 40 combined years of experience in Indiana Medicaid Waiver experience, serving people with developmental disabilities. Erica and Melissa are passionate about providing quality individualized services to those in need. It is New Wave's belief that every individual deserves to have the opportunity to live a full and meaningful life.

Counties We Serve

ADAMS, ALLEN, BACKFORD, CASS, CLINTON,
DEKALB, DELEWARE, GRANT, HAMILTON,
HUNTINGTON, LAGRANGE, LAKE MARION, MIAMI
NOBLE, PORTER, TIPPECANOE, WABASH, WELLS,
AND WHITLEY

Our Services

Behavior Management

Effective behavioral management requires teaching a new skill/appropriate behavior to replace an inappropriate behavior. Assessments and Behavior Support Plans are completed to target problem behaviors and provide our team with methods to support the individual by teaching more appropriate alternative behaviors.

Music Therapy

The clinical and evidence based use of music interventions to accomplish individualized goals within a therapeutic relationship by a credentialed professional . Music therapy interventions are designed to: promote wellness, manage stress, alleviate pain, express feelings, enhance memory, improve communication, and promote physical rehabilitation

Recreational Therapy

CTRS are part of a multi-disciplinary treatment team, assessing clients/patients, developing individualized treatment plans, applying a variety of recreation and leisure oriented interventions, and helping clients/patients make a successful transition back to their homes and community.

Coming Soon

Medicaid Counseling Services

201 E Rudisill Blvd. Ste 102B
Fort Wayne, IN 46806
Phone: 260-557-5519
E-mail: info@newwavewellness.org



HELPING PEOPLE MOVE THROUGH LIFE.



National Seating & Mobility (NSM) brings together industry-leading expertise, uniquely engineered systems and breakthrough technologies to provide products and services that help our clients move through life. NSM is the only national provider of complete mobility solutions with a national network of professionals and dedicated specialists focused on Complex Rehab Technology (CRT), Home & Vehicle Accessibility, and Service.

For more information about NSM services contact:

510 Incentive Dr
Ft. Wayne, IN 46825-3376
Phone (260) 489-5200
Fax (260) 489-4001



**NATIONAL
SEATING &
MOBILITY**

LET'S GET *moving*

PROUD SPONSOR OF THE DISABILITIES EXPO

Educational Services/Support

ABLE Program Huntington University
Advocacy Links Resource and Advocacy Center
Allen County Public Library
Camp Red Cedar
CASS Housing
Collab-Unity
CORE Vocational Training for Individuals with Disabilities
D.E.W. Disability Education Warehouse
DSANI (Down Syndrome Association of Northeast Indiana)
Fort Wayne Chapter, Indiana Association of Workers for the Blind
Fort Wayne Parks & Recreation Community Center Sensory Clubhouse
GiGi's Playhouse Fort Wayne
IN*SOURCE
Indiana Educational Scholarship Account
Indiana Family to Family
Mizpah Shrine Center - Shriners Children's
Pathfinder Services
PQCTRAINS
Purdue University Fort Wayne
Sara's Garden / Special Grounds Coffee Co.
Sensory Awareness Education & Outreach
The Arc of Indiana
The Arc of LaGrange County
The League
Turnstone
VA Northern Indiana Health Care System
Visually Impaired Preschool Services

Employment Services

CORE Vocational Training for Individuals with Disabilities
Easterseals Arc Of Northeast Indiana
Family \$ Social Services Vocational Rehabilitation
Fort Wayne Metals
Goodwil Industries of Northeast Indiana
Kroger
Meijer
Partners in Autism
Pathfinder Services
PQCTRAINS
Rural King
The Arc of LaGrange County
VA Northern Indiana Health Care System
Walgreens

Family Nurturing, Support, & Guidance

Advocacy Links Resource and Advocacy Center
Collab-Unity
DSANI (Down Syndrome Association of Northeast Indiana)
Indiana Family to Family
Learn From Autistic People
Mizpah Shrine Center - Shriners Children's
My Autism Ally
Pathfinder Services
The Arc of Indiana
The Arc of LaGrange County
Turnstone
VA Northern Indiana Health Care System
Writing by Gloria

First Steps

GiveHear
Pathfinder Services
Visually Impaired Preschool Services

Healthcare Services

A Rosie Place for Children
Anthem Blue Cross and Blue Shield
Bluffton Regional Medical Center Rehabilitation Services
CareSource
Collab-Unity
Forte Residential & Forte Home Health Care
GiveHear
HomePointe HealthCare
Humana
Indiana University Skills on Wheels
Lutheran Hospital Outpatient Rehabilitation
Meridian Health Services
Mizpah Shrine Center - Shriners Children's
Sara's Garden / Special Grounds Coffee Co.
SRT Prosthetics & Orthotics
Summit City Prosthetics & Orthotics
The League
VA Northern Indiana Health Care System

Legal/Financial

Connections Case Management
Dale Huffman & Babcock Lawyer
Fletcher Van Gilder, Attorneys at Law
Forbes Disability Group
INvestABLE Indiana
Mizpah Shrine Center - Shriners Children's
Pathfinder Services
The Arc of Indiana Master Trust
Volunteer Lawyer Program of Northeast Indiana

Prosthetics & Orthotics

SRT Prosthetics & Orthotics
Summit City Prosthetics & Orthotics

Residential Services/Housing

AID of Indiana
Bath Planet of Indiana
CASS Housing
Easterseals Arc Of Northeast Indiana
Indiana MENTOR/Sevita Health
Mobility Plus Columbia City
Pathfinder Services
ResCare Community Living
Special Stars Baseball Clinic
The Arc of LaGrange County
UniqueHab Solutions
Window Works

Respite

A Rosie Place for Children
Agape Respite Care
Easterseals Arc Of Northeast Indiana

Service Animals

Camp Red Cedar
Canine Companions

SLP, PT, OT, Rec Therapy

Bluffton Regional Medical Center Rehabilitation Services
F.L.O.W. Recreation
Hursh Speech Therapy and Sprout Speech Therapy
Indiana University Skills on Wheels
Maple Seed Farms
Mizpah Shrine Center - Shriners Children's
PRC-Salttillo
Pure Abilities Therapeutic Services
Sara's Garden / Special Grounds Coffee Co.
Turnstone
VA Northern Indiana Health Care System
Visually Impaired Preschool Services

Social Programming

Advocacy Links Resource and Advocacy Center
Aktion Club
Bring It Push It Own It
Camp Red Cedar
Collab-Unity
DSANI (Down Syndrome Association of Northeast Indiana)
Family & Social Services Vocational Rehabilitation
Family and Social Services Administration Office of Healthy Opportunities
Fort Wayne Chapter, Indiana Association of Workers for the Blind
Fort Wayne Parks & Recreation Community Center Sensory Clubhouse
I CAN Service Team- Volunteer Center
Jesters of University of Saint Francis
Joyful Songsters - Community Choirs of Huntington County
Life Adult Day Academy
Mizpah Shrine Center - Shriners Children's
Partners in Autism
PQCTRAINS
Sara's Garden / Special Grounds Coffee Co.
Turnstone
VA Northern Indiana Health Care System
YMCA of Greater Fort Wayne

System Navigation (Resources)

Advocacy Links Resource and Advocacy Center
CONNECT Allen County
Family & Social Services Vocational Rehabilitation
Family and Social Services Administration Office of Healthy Opportunities
Indiana Disability Resource FINDER
Indiana Family to Family
Mizpah Shrine Center - Shriners Children's
My Autism Ally
The Arc of Indiana
The League
Turnstone
VA Northern Indiana Health Care System

Transportation

Community Transportation Network
Life Adult Day Academy
Mizpah Shrine Center - Shriners Children's
Superior Van & Mobility
The Arc of LaGrange County

Waiver Services

A Rosie Place for Children
Agape Respite Care
AID of Indiana
Autism Society of Indiana
AWRC Industries
Camp Red Cedar
CareStar of Indiana
Center for Life Transitions
Connections Case Management
Easterseals Arc Of Northeast Indiana
Ferraro Behavior Services
Forte Residential & Forte Home Health Care
Georges Pharmacy and Medical Equipment
HomePointe HealthCare
Indiana Professional Management Group (IPMG)
Inspire Case Management
LEL Home Services
Life Adult Day Academy
Maple Seed Farms
New Leaf Recreation
New Wave Wellness
Partners in Autism
Pathfinder Services
Positive Pathways Counseling and Consulting
PQCTRAINS
Pure Abilities Therapeutic Services
ResCare Community Living
The Arc of Indiana
The Arc of LaGrange County
The Columbus Organization
Torres Behavioral Health
True North Consulting Group
Turnstone

Other

W.E.L.T. 95.7fm Community Radio (AppleOrchardKnewz)
Agape Mobility Ethiopia
Daniel Williams - Author
LJ's Discount Medical
SLS Royal Fashions, LLC, Perfectly Imperfect
Spectrum Radio
The MINDCAP Center



**Working together
for better health**

**Anthem Blue Cross and Blue Shield –
your choice for a healthy life.**

Visit us at www.anthem.com/inmedicaid.

Serving Hoosier Healthwise, Healthy Indiana Plan
and Hoosier Care Connect

Anthem Blue Cross and Blue Shield is the trade name of Anthem Insurance Companies, Inc., independent licensee of the Blue Cross and Blue Shield Association. Anthem is a registered trademark of Anthem Insurance Companies, Inc.



- Providing Therapy In Home, In School, and In Day Care, across the state of Indiana!
- Ages 18 Mo. - 12 Yrs old!
- Accepting Medicaid and other major Insurance Providers!
- No Waitlist!



Total Care
therapy

**Helping your child succeed
through ABA Therapy**

404-400-5004 | INFO@TOTALCAREABA.COM | @TOTALCAREABA



FLETCHER VAN GILDER LLP



Your Choice For Social Security Disability Advocacy

Attorneys Lindsay D. Solon and Audrey M. Van Gilder represent adult claimants at all stages of the disability process, including federal court appeals. Reach us by phone or online, and meet your disability lawyer in-person at our accessible downtown Fort Wayne location.

📍 436 E WAYNE ST. FORT WAYNE, IN 46802 📞 260.425.9777 🌐 FVGLAW.COM





Assistance • Independence • Dignity

📞 260.444.3433

🌐 aidofindiana.com

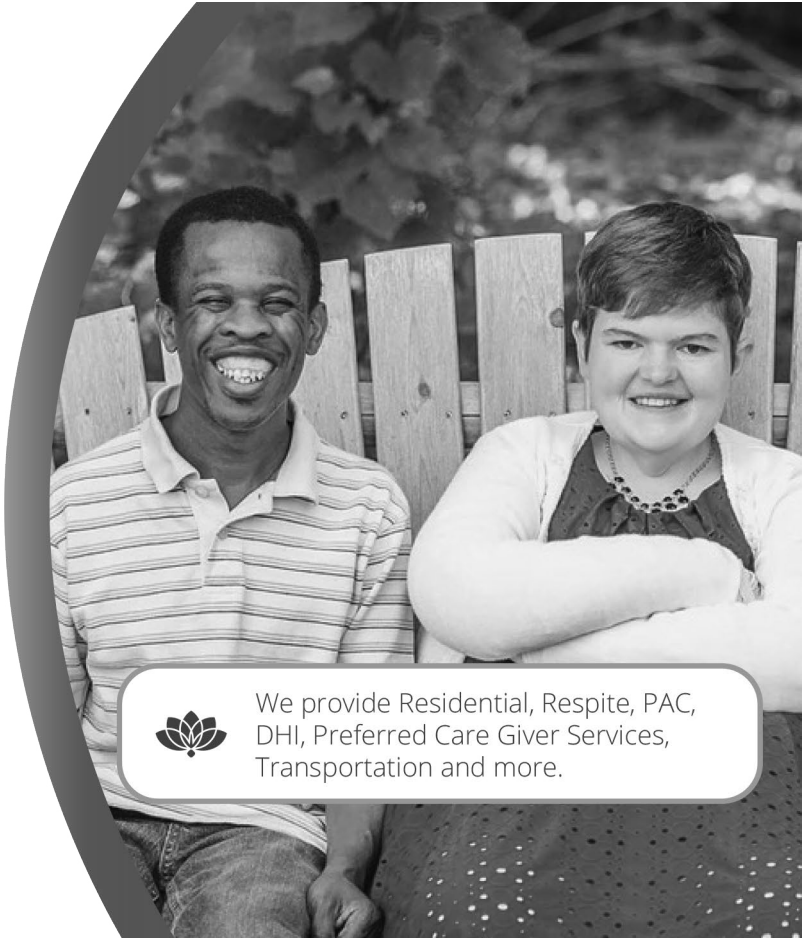
📍 9434 Lima Road
Fort Wayne, IN 46818



 We provide Residential, Respite, PAC, DHI, Preferred Care Giver Services, Transportation and more.

Find some great resources? Take notes here!



Our mission is to provide and promote opportunities that empower people with disabilities to achieve their potential.

Programs and Services:

- Adaptive Equipment
- Advocacy - Individual & Systemic
- Benefit Enrollment Center
- Braille & Large Print Transcription
- Deaf/Hard-of-Hearing Case Coordination
- Inclusion Institute
- Independent Living Skills Training
- Information & Referral Services
- Home Care & Home Health Care
- Nursing Home to Home Transition
- Orientation & Mobility Training
- Peer Support Groups
- Senior Blind Services
- Sign Language Interpreting
- Youth Services, and more!

5821 S. Anthony Blvd, Ft. Wayne, IN 46816
www.the-league.org ● 260-441-0551



100% Employee-Owned!

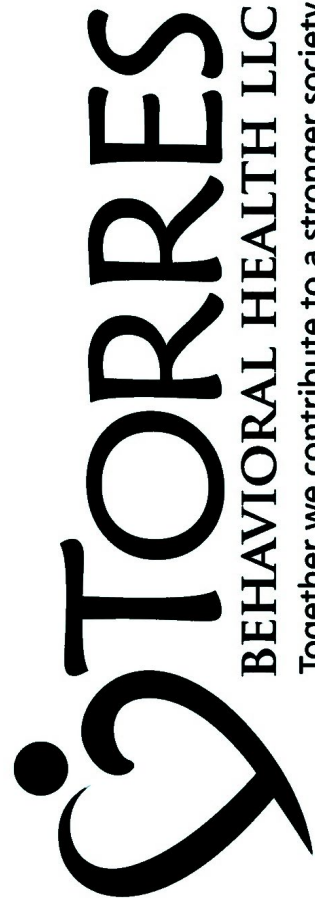

TORRESBEHAVIORALHEALTH.COM



Recreational Therapy & Behavior Management



www.NewLeafRT.com • Admin@NewLeafRT.com



FINANCIAL OPPORTUNITY CENTER

Unlock financial stability without red tape



Financial and Benefits Counseling

- Improve your credit rating
- Balance your income and benefits
- Build wealth with budgeting and saving techniques

Income Supports

- Navigate social service benefits
- Access resources to support you with immediate and future needs

Employment and training for the perfect career

- Build job search strategies
- Learn interview techniques
- Meet potential employers
- Career development
- Get hired!



We work alongside you to map out a path to achieve your goals.



for more information visit

PATHFINDERSERVICES.ORG



RURAL LISC

Turning 65 or new to Medicare?

Do you have Medicare and Medicaid?



If so, check out this Humana DSNP

With a Medicare Advantage Dual Eligible Special Needs Plan (DSNP), you may be able to help simplify your healthcare. Humana Gold Plus SNP-DE H5619-054 (HMO D-SNP) has everything Original Medicare has—and usually more, such as:

- Humana Healthy Options allowance, with \$150 a month to help pay for essentials like eligible groceries, rent and utilities; your unused dollars do not roll over each month*
- \$3,000 dental coverage annually for select services, plus exams, X-rays, cleanings and more†
- Rides to your doctors—48 routine one-way trips‡

Call a licensed Humana sales agent



Marquetta Brabson-William
260-403-2246 (TTY: 711)
8 a.m. – 5 p.m.
MBrabsonWilliam1@humana.com

Humana. A more human way to healthcare™

* Allowance amounts cannot be combined with other benefit allowances, used to purchase Medicare-covered prescriptions or converted to cash. Limitations and restrictions may apply.

† Costs, coverage, and benefits vary by location.

‡ This benefit is not to exceed 75 miles per trip.

Serving individuals with disabilities in their homes since 1992.



Forte
RESIDENTIAL &
HOME HEALTH CARE



forteresidential.org
574-549-9961

Floor Plan

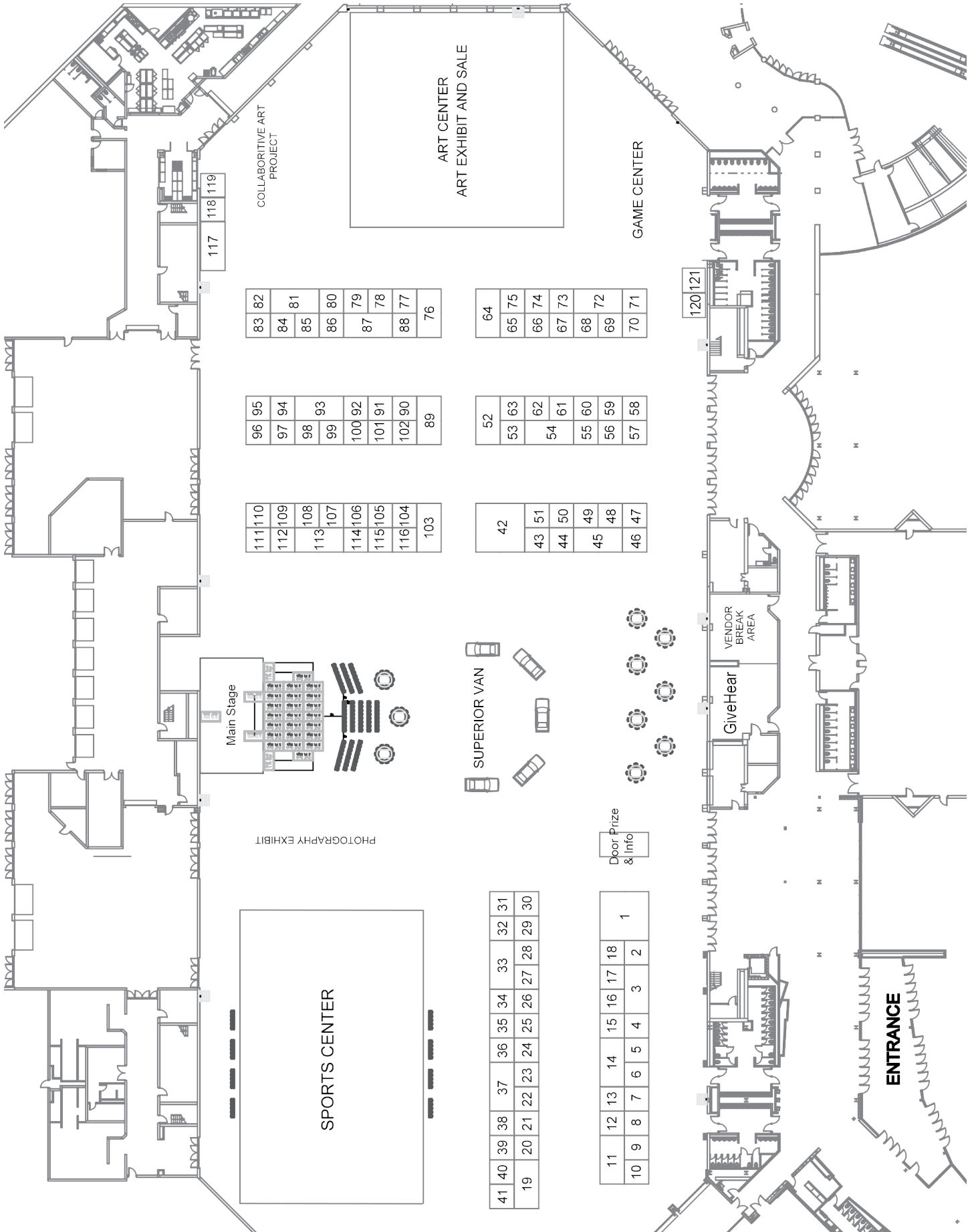

83	82
84	81
85	80
86	79
87	78
88	77
76	

64	65	75
66	74	73
68	72	71

96	95
97	94
98	93
99	92
100	91
101	90
102	89

52	53	63
54	61	62
55	60	59
56	58	57

111	110
112	109
108	107
113	106
114	105
115	104
116	103

42	43	51
44	50	49
45	48	47

41	40	39	38	37	36	35	34	33	32	31	
19	20	21	22	23	24	25	26	27	28	29	30

11	12	13	14	15	16	17	18	1
10	9	8	7	6	5	4	3	2

PHOTOGRAPHY EXHIBIT

Main Stage

SUPERIOR VAN

Door Prize & Info

GiveHear

VENDOR BREAK AREA

ENTRANCE

Exhibitors

Booth & Company

1.....Indiana Disability Resource FINDER
2.....Fort Wayne/Allen Co. Disability Council
3.....Sara's Garden/Special Grounds Coffee Co
4.....LLC K-9 Comfort Dog Ministry
5.....Visually Impaired Preschool Services
6.....Children's Autism Center
7.....LEL Home Services
8.....Indiana Educational Scholarship Account
9.....Window Works
10.....Vernon Health and Rehab
11.....ResCare Community Living
12.....DSANI (Down Syndrome Association of Northeast Indiana)
13.....Total Care ABA
14.....The INDATA Project at Easterseals Crossroads
15.....A Rosie Place for Children
16.....UniqueHab Solutions LLC
17.....Mizpah Shrine Center
18.....Aktion Club
19.....Pathfinder Services
20.....SRT Prosthetics & Orthotics
21.....VA Northern Indiana Health Care System
22.....Center for Life Transitions
23.....True North Consulting Group, Inc.
24.....D.E.W. Disability Education Warehouse
25.....The Arc of LaGrange County
26.....INVESTABLE Indiana
27.....Metropolitan Human Relations Commission
28.....Fort Wayne Chapter, Indiana Association of Workers for the Blind
29.....CASS Housing
30.....YOURspace Inc.
31.....Sensory Awareness Education & Outreach Inc.
32.....Special Stars Baseball Clinic
33.....National Seating & Mobility
34.....We Carry Kevan
35.....Turnstone
36.....SLS Royal Fashions, LLC, Perfectly Imperfect
37.....New Wave Wellness
38.....Collab-Unity
39.....Ferraro Behavior Services
40.....Aging & In-Home Services
41.....F.L.O.W. Recreation LLC
42.....Partners in Autism
43.....Hursh Speech Therapy & Sprout Speech Therapy
44.....Daniel Williams - Author
45.....The League
46.....W.E.L.T 95.7 Community Radio (AppleOrchardKnewz)
47.....Writing by Gloria
48.....Lutheran Hospital Outpatient Rehabilitation
49.....Bluffton Regional Medical Center Rehabilitation Services
50.....Purdue University Fort Wayne
51.....Community Transportation Network
52.....GiGi's Playhouse Fort Wayne
53.....Allen County Public Library
54.....AID of Indiana
55.....Fletcher Van Gilder, Attorneys at Law
56.....Volunteer Lawyer Program of Northeast Indiana
57.....Dale Huffman & Babcock Lawyers
58.....Torres Behavioral Health
59.....Indiana Family to Family
60.....PRC-Salttillo

61.....The Mindcap Center
62.....IN*SOURCE
63.....CareStar of Indiana
64.....AutoFarm Mobility
65.....CONNECT Allen County
66.....Forbes Disability Group
67.....American Medicare Disability Advocates
68.....CareSource
69.....Forte Residential, Inc. & Forte Home Health Care, Inc.
70.....Summit City Prosthetics & Orthotics
71.....YMCA of Greater Fort Wayne
72.....Pure Abilities Therapeutic Services
73.....I CAN Service Team - Volunteer Center
74.....Maple Seed Farms
75.....Anthem Blue Cross and Blue Shield
76.....Mobility Plus Columbia City
77.....Life Adult Day Academy
78.....Fort Wayne Parks & Recreation Community Center Sensory Clubhouse
79.....The Columbus Organization
80.....Humana
81.....My Autism Ally
82.....Canine Companions
83.....Inspire Case Management
84.....Positive Pathways Counseling & Consulting
85.....Family & Social Services Administration Office of Healthy Opportunities
86.....Family & Social Services Administration of Disability & Rehabilitative Services Vocational Rehabilitation
87.....AWRC Industries
88.....HomePointe HealthCare
89.....Meridian Health Services
90.....Camp Red Cedar
91.....Advocacy Links Resource & Advocacy Center
92.....Indiana Professional Management Group (IPMG)
93.....George's Pharmacy & Medical Equipment
94.....CORE Vocational Training for Individuals with Disabilities
95.....Autism Society of Indiana
96.....Connections case Management LLC
97.....Walgreens
98.....Meijer
99.....Fort Wayne Metals
100...Goodwill Industries of Northeast Indiana
101...Kroger
102...Rural King
103...PQC Trains
104...New Leaf Recreation, LLC
105...Indiana Talking Book and Braille Library
106...ABLE Program Huntington University
107...Easterseals Arc of Northeast Indiana
108...Indiana MENTOR/Sevita Health
109...Agape Respite Care, Ince.
110...Bureau of Development Disability Services (BDDS)
111...Joyful Songsters
112...Learn from Autistic People
113...Chea Clothing LLC
114...Fort Wayne Dance Collective
115...Spectrum Radio
116...Jesters of University of Saint Francis
117...Agape Mobility Ethiopia
118...The Arc of Indiana Master Trust
119...The Arc of Indiana
120...Voter Registration & Information
121...Indiana University Skills on Wheels GiveHear.....GiveHear Main Floor.....Superior Van & Mobility

Alphabetical Listing

A Rosie Place for Children.....15
ABLE Program Huntington University.....106
Advocacy Links Resource and Advocacy Center.....91
Agape Mobility Ethiopia.....117
Agape Respite Care.....109
Aging & In-Home Services.....40
AID of Indiana.....54
Aktion Club.....18
Allen County Public Library.....53
American Medicare Disability Advocates.....67
Anthem Blue Cross and Blue Shield.....75
Autism Society of Indiana.....95
AutoFarm Mobility.....64
AWRC Industries.....87
Bluffton Regional Medical Center Rehabilitation Services.....49
Bureau of Development Disability Services (BDDS).....110
Camp Red Cedar.....90
Canine Companions.....82
CareSource.....68
CareStar of Indiana.....63
CASS Housing, Inc.....29
Center for Life Transitions.....22
Chea Clothing LLC.....113
Children's Autism Center.....6
Collab-Unity.....38
Community Transportation Network.....51
CONNECT Allen County.....65
Connections Case Management LLC.....96
CORE Vocational Training for Individuals with Disabilities.....94
D.E.W. Disability Education Warehouse.....24
Dale Huffman & Babcock Lawyer.....57
Daniel Williams - Author.....44
DSANI (Down Syndrome Association of Northeast Indiana).....12
Easterseals Arc Of Northeast Indiana.....107
F.L.O.W. Recreation LLC.....41
Family and Social Services Administration Division of Disability and Rehabilitative Services Vocational Rehabilitation.....86
Family and Social Services Administration Office of Healthy Opportunities.....85
Ferraro Behavior Services.....39
Fletcher Van Gilder, Attorneys at Law.....55
Forbes Disability Group.....66
Fort Wayne Chapter, Indiana Association of Workers for the Blind.....28
Fort Wayne Dance Collective.....114
Fort Wayne Metals.....99
Fort Wayne Parks & Recreation Community Center Sensory Clubhouse.....78
Fort Wayne/Allen County Disability Council.....2
Forte Residential, Inc. and Forte Home Health Care, Inc.....69
Georges Pharmacy and Medical Equipment.....93
GiGi's Playhouse Fort Wayne.....52
Goodwill Industries of Northeast Indiana.....100
HomePointe HealthCare.....88
Humana.....80
Hursh Speech Therapy and Sprout Speech Therapy.....43
I CAN Service Team- Volunteer Center.....73
IN*SOURCE.....62
Indiana Disability Resource FINDER.....1
Indiana Educational Scholarship Account.....8
Indiana Family to Family.....59
Indiana MENTOR/Sevita Health.....108
Indiana Professional Management Group (IPMG).....92
Indiana Talking Book and Braille Library.....105

Indiana University Skills on Wheels.....	121	Advocacy Links, LLC 56159 Riverdale Dr. Elkhart, IN 46514 574-370-8205 advocacy-links.com	Camp Red Cedar 3900 Hursh Rd. Fort Wayne, IN 46845 260-637-3608 campredcedar.com
Inspire Case Management.....	83	Agape Mobility Ethiopia PO Box 15291 Fort Wayne, IN 46885 260-498-7862 agapemobilityethiopia.com	Canine Companions 10197 S 100 East Keystone, IN 46759 260-273-2064 canine.org
INVESTABLE Indiana.....	26	Agape Respite Care 298 Emmental Dr., PO Box 84 Berne, IN 46711 260-589-3351 agaperespite.org	CareSource 135 N Pennsylvania St. Indianapolis, IN 46204 260-437-0465 caresource.com
Jesters of University of Saint Francis.....	116	Aging & In-Home Services of Northeast Indiana, Inc. 8101 W Jefferson Blvd. Fort Wayne, IN 46804 260-745-1200 agingihs.org	CareStar of Indiana, LLC 1075 Broad Ripple Ave. #316 Indianapolis, IN 46220 463-800-2315 carestar.com/case-management/programs/ indiana
Joyful Songsters.....	111	AID Residential Services 9434 Lima Rd. Fort Wayne, IN 46825 260-444-3433 aidofindiana.com	CASS Housing PO Box 10778 Fort Wayne, IN 46805 260-615-3047 casshousing.org
Kroger.....	101	Aktion Club jeffrey.scherer16@gmail.com	Center for Life Transitions 2324 Lake Ave. Fort Wayne, IN 46805 260-201-1900 cflctconnect.com
Learn From Autistic People.....	112	Allen County Public Library 7615 Disalle Blvd. Fort Wayne, IN 46825 260-421-1337 acpl.info	Chea Clothing LLC 3539 Beluga Ln., Apt. 1B Indianapolis, IN 46214 317-828-9742 cheaclothing.net
LEL Home Services.....	7	American Medicare Disability Advocates 429 E Dupont, Box 143 Fort Wayne, IN 46825 574-453-6745 amdamedicare.org	Children's Autism Center 5601 Coventry Lane Fort Wayne, IN 46804 260-459-6040 childrensautismcenter.org
Life Adult Day Academy.....	77	Anthem Blue Cross and Blue Shield 220 Virginia Ave. Indianapolis, IN 46204 317-220-0877 anthem.com/inmedicaid	Collab-Unity 260-413-1260 rebekahlunt.fbs@outlook.com
LLC K-9 Comfort Dog Ministry.....	4	Autism Society of Indiana 10255 Commerce Dr., Suite 164 Fishers, IN 46032 317-667-9211 autismsocietyofindiana.org	Community Transportation Network (CTN) 5601 Industrial Rd. Fort Wayne, IN 46825 260-420-3280 ridectn.org
Lutheran Hospital Outpatient Rehabilitation.....	48	AutoFarm Mobility LLC 9004 S CR 800 W Daleville, IN 47334 765-354-2261 autofarmmobility.com	CONNECT Allen County 201 E Rudisill Blvd., Suite 102B Fort Wayne, IN 46806 260-901-5480 connectallencounty.com
Maple Seed Farms, Inc.....	74	AWRC Industries 5620 Industrial Rd. Fort Wayne, IN 46825 260-207-5780 awrcindustries.com	Connections Case Management 9165 Otis Ave., Suite 217 Indianapolis, IN 46216 317-710-7184 connectionsinc.com
Meijer.....	98	Bluffton Regional Medical Center Rehabilitation Services 303 S Main St. Bluffton, IN 46714 260-919-3282 blufftonregional.com/rehab-services	CORE Vocational Training Program for Individuals with Disabilities 839 Northcrest Shopping Center Fort Wayne, IN 46805 260-438-4521 corevocationaltraining.org
Meridian Health Services.....	89	Bureau of Developmental Disability Services 201 E Rudisill Blvd., Suite 300 Fort Wayne, IN 46806 260-423-2571 in.gov/fssa/ddrs/	D.E.W. Disability Education Warehouse 4701 N Hollywood Ave. Munice, IN 47304 219-741-2915 disabilityeducationwarehouse.com
Metropolitan Human Relations Commission.....	27		
Mizpah Shrine Center - Shriners Children's.....	17		
Mobility Plus Columbia City.....	76		
My Autism Ally.....	81		
National Seating & Mobility.....	33		
New Leaf Recreation, LLC.....	104		
New Wave Wellness.....	37		
Partners in Autism.....	42		
Pathfinder Services.....	19		
Positive Pathways Counseling and Consulting, LLC.....	84		
PQCTRAINS.....	103		
PRC-Salttillo.....	60		
Purdue University Fort Wayne.....	50		
Pure Abilities Therapeutic Services.....	72		
ResCare Community Living.....	11		
Rural King.....	102		
Sara's Garden / Special Grounds Coffee Co.....	3		
Sensory Awareness Education & Outreach.....	31		
SLS Royal Fashions, LLC, Perfectly Imperfect.....	36		
Special Stars Baseball Clinic.....	32		
Spectrum Radio.....	115		
SRT Prosthetics & Orthotics.....	20		
Summit City Prosthetics & Orthotics.....	70		
Superior Van & Mobility.....	SuperiorVan		
The Arc of Indiana.....	119		
The Arc of Indiana Master Trust.....	118		
The Arc of LaGrange County.....	25		
The Columbus Organization.....	79		
The INDATA Project at Easterseals Crossroads.....	14		
The League.....	45		
THE MINDCAP CENTER.....	61		
Torres Behavioral Health.....	58		
Total Care ABA.....	13		
True North Consulting Group, Inc.....	23		
Turnstone.....	35		
UniqueHab Solutions LLC.....	16		
VA Northern Indiana Health Care System.....	21		
Vernon Health & Rehab.....	10		
Visually Impaired Preschool Services.....	5		
Volunteer Lawyer Program of Northeast Indiana.....	56		
Voter Registration & Information.....	120		
W.E.L.T. 95.7fm Community Radio (AppleOrchardKnewz).....	46		
Walgreens.....	97		
We Carry Kevan.....	34		
Window Works.....	9		
Writing by Gloria.....	47		
YMCA of Greater Fort Wayne.....	71		
YOURspace Inc.....	30		

Exhibitors Information

A Rosie Place
53131 Quince Rd.
South Bend, IN 46628
574-235-8899
arosieplace.org

ABLE Huntington University
2303 College Ave.
Huntington, IN 46750
260-438-5124
huntington.edu/able-program

Exhibitors Information

Dale Huffman & Babcock Lawyer
30 Premier Ave.
Bluffton, IN 46714
260-824-5566
dhblaw.com

Daniel Williams - Author
260-452-5701
danielh6010@yahoo.com
Instagram: @dan_delightful
Twitter: @dan_delightful
TikTok: daniel_wills27 or Daniel Williams
YouTube: danielh60
Amazon: My Voice: Faced with Autism

Down Syndrome Association of Northeast
Indiana(DSANI)
3320 N. Clinton
Fort Wayne, IN 46805
260-471-9964
dsani.org

Easterseals Arc of Northeast Indiana
4919 Coldwater Rd.
Fort Wayne, IN 46825
260-456-4534
eastersealsarcnein.org

F.L.O.W. Recreation LLC
9109 Stellhorn Crossing Pkwy, Suite B
Fort Wayne, IN 46815
330-979-9576
flowrectherapy.com

Family & Social Services Administration
Division of Disability & Rehabilitative Services
Vocational Rehabilitation
201 E Rudisill, Suite 300
Fort Wayne, IN 46806
269-425-1718
in.gov/fssa/ddrs/rehabilitation-employment/
vocational-rehabilitation-employment

Family & Social Services Administration
Office of Healthy Opportunities
201 E Rudisill, Suite 300
Fort Wayne, IN 46806
260-224-3733
in.gov/fssa/office-of-healthy-opportunities

Ferraro Behavior Services, LLC
9512 Lima Rd., Suite 103
Fort Wayne, IN 46818
260-414-4713
ferrarobehaviorservices.com

Fletcher Van Gilder, Attorneys at Law
436 E Wayne St.
Fort Wayne, IN 46802
260-557-6082
fvglaw.com

Forbes Disability Group
312 North Wayne St., PO Box 374
Angola, IN 46703
260-319-0515
needsocialsecurity.com

Fort Wayne Chapter - Indiana Association of
Workers for the Blind
1730 Colony Dr.
Fort Wayne, IN 46825
260-438-9216
workersfortheblind.org

Fort Wayne Dance Collective
437 E Berry St., Suite 203
Fort Wayne, IN 46802
260-424-6574
fwdc.org

Fort Wayne Metals
9609 Ardmore Ave.
Fort Wayne, IN 46809
fwmetals.com

Fort Wayne Parks & Recreation Community
Center Sensory Clubhouse
233 W Main St.
Fort Wayne, IN 46802
260-255-2560
fortwayneparks.org

Fort Wayne-Allen County Disability
Advisory Council
facebook.com/fwacdac

Fort Residential, Inc.
Fort Home Health Care, Inc.
120 S Lake St., Suite 100
Warsaw, IN 46580
574-549-9961
forteresidential.org

George's Pharmacy & Medical Equipment
6425 Cross Creek Blvd.
Fort Wayne, IN 46818
260-289-6666
georgespharmacy.com

GiGi's Playhouse Fort Wayne
6081 North Clinton St
Fort Wayne, IN 46825
260-482-7529
gigisplayhouse.org/fortwayne

GiveHear
130 W Main St., Ste. 150
Fort Wayne, IN 46802
260-399-9863
givehear.org

Goodwill Industries of Northeast
Indiana, Inc.
1516 Magnavox Way
Fort Wayne, IN 46804
260-602-8526
fwgoodwill.org

HomePointe HealthCare
8515 Bluffton Rd.
Fort Wayne, IN 46809
260-748-7913
homepointecares.com

Humana
7035 E 96th St., Ste. F
Indianapolis, IN 46250
317-771-3049
humana.com

Hursh Speech Therapy and
Sprout Speech Therapy
421 E Cook Rd., Suite 200
Fort Wayne, IN 46825
hurshspeechtherapyfw@gmail.com
sproutspeechtherapy@gmail.com
sproutspeechtherapyfw.com

I CAN Service Team- Volunteer Center
3401 Lake Ave., Suite 4
Fort Wayne, IN 46805
260-424-3505
volunteerfortwayne.org

IN*SOURCE
701 N Niles Ave., Suite 110
South Bend, IN 46617
574-234-7101
insource.org

Indiana Disability Resource FINDER
5323 W Jefferson Blvd.
Fort Wayne, IN 46804
260-207-5728
indianadisabilityresourcefinder.org

Indiana Educational Scholarship Account
101 W Ohio St., Suite 1450
Indianapolis, IN 46151
317-447-2496
in.gov/tos/inesa

Indiana Family to Family
8435 Keystone Crossing, Suite 190
Indianapolis, IN 46240
317-257-8683
inf2f.org

Indiana MENTOR/Sevita Health
5800 Fairfield Ave., Suite 125
Fort Wayne, IN 46807
260-485-5899
sevitahealth.com

Indiana Professional Management Group (IPMG)
1305 Cumberland Ave., Ste. 225
West Lafayette, IN 47906
866-286-2563
gotoipmg.com

Indiana Talking Book & Braille Library
140 N Senate Ave.
Indianapolis, IN 46204
317-232-0609
in.gov/library/tbbl

Inspire Case Management
PO Box 42826
Indianapolis, IN 46242
765-749-9395
inspirecm.com

INvest ABLE Indiana
One North Capitol, Ste. 900
Indianapolis, IN 46204
317-232-1614
in.savewithable.com

Jesters of the University of Saint Francis
2701 Spring St.
Fort Wayne, IN 46808
260-750-4838
sf.edu/about/camps-and-community-programs/
jesters-2/

Joyful Songsters - Community Choirs of
Huntington County
PO Box 293
Huntington, IN 46750
260-224-3706
childrenschoirofhuntingtoncounty.org

Kroger
4120 N Clinton St.
Fort Wayne, IN 46805
260-473-3467
jobs.kroger.com

Learn from Autistics
51865 Pennyroyal Ln.
Granger, IN 46530
260-348-2766
learnfromautistics.com

LEL Home Services
5936 N Keystone Ave.
Indianapolis, IN 46220
317-387-1443
lelhomeservices.com

Exhibitors Information

Life Adult Day Academy
7515 Westfield Dr.
Fort Wayne, IN 46825
260-403-2843
ladafw.com

LJ's Discount Medical
737 N Coliseum Blvd.
Fort Wayne, IN 46805
260-444-5105
ljsdiscountmedical.net

LLC K-9 Comfort Dog Ministry
jared@k9comfort.org

Lutheran Hospital Outpatient
Rehabilitation
7919 W Jefferson Blvd.
Lutheran Medical Building 3rd Floor
Fort Wayne, IN 46804
260-435-7787
lutheranhealth.net

Maple Seed Farms, Inc.
101 W Dupont Rd.
Fort Wayne, IN 46765
260-415-8189
mapleseedfarms.org

Meijer

Meridian Health Services
2620 Lake Ave.
Fort Wayne, IN 46805
260-436-0932
meridianhs.org

Metropolitan Human
Relations Commission
2310 Parnell Ave.
Fort Wayne, IN 46805
260-427-1146
fortwaynemetrol.org

Mizpah Shrine
1015 Memorial Way
Fort Wayne, IN 46805
260-426-4543
mizpahshrine.com

Mobility Plus Columbia City
220 Frontage Rd., Suite A
Columbia City, IN 46725
260-503-6066
mobilityplus.com/columbiacity

My Autism Ally
PO Box 15
Huntertown, IN 46748
260-207-4686
myautismally.org

National Seating & Mobility, Inc.
3927 Kraft Parkway, Unit A
Fort Wayne, IN 46808
260-438-1446
nsm-seating.com

New Leaf Recreation, LLC
104 E Collins Rd.
Fort Wayne, IN 46825
260-403-0627
newleafrt.com

New Wave Wellness
201 E Rudisill Blvd.
Fort Wayne, IN 46807
765-207-0020
newwavewellness.org

Partners in Autism
601 Noble Dr.
Fort Wayne, IN 46825
260-420-9332
partnersinautism.com

Pathfinder Services
2824 Theater Ave.
Huntington, IN 46750
734-265-0709
pathfinderservices.org

Positive Pathways Counseling &
Consulting, LLC
969 Keystone Way, Suite 100
Carmel, IN 46032
317-914-5931
positivepathways.net

PQCTrains
4211 Hobson Court, Ste. A
Fort Wayne, IN 46815
260-420-7374
pqctrains.com

PRC-Salttillo
1022 Heyl Rd.
Wooster, OH 44691
800-262-1984
prc-salttillo.com

Purdue University Fort Wayne
2101 E Coliseum Blvd.,
Fort Wayne, IN 46805
260-481-5742
pfw.edu/SOE

Pure Abilities Recreational Therapy
1910 St. Joe Center Rd., Suite 54
Fort Wayne, IN 46825
330-441-2258
pureabilities.com

ResCare Community Living
4410 Executive Blvd.
Fort Wayne, IN 46808
260-705-2531
brightspringhealth.com

Rural King

Sara's Garden/Special Grounds
Coffee Co.
620 W Leggett St., PO Box 150
Wauseon, OH 43567
419-335-7272
sarasgarden.org

Sensory Awareness Education &
Outreach Inc.
3301 E Coliseum Blvd.
Fort Wayne, IN 46805
260-444-6009
sensoryfunandplayroom.com

SLS Royal Fashions LLC,
Perfectly Imperfect
260-210-4940
sharelashorter2015@gmail.com

Special Stars Baseball Clinic
6512 Landmark Dr.
Fort Wayne, IN 46815
260-435-0228
facebook.com/specialstarsbaseball

Spectrum 23.9 Online Radio
2309 Longleaf Dr.
Fort Wayne, IN 46814
260-402-7591
thespectrum239.com

SRT Prosthetics & Orthotics
3818 W Jefferson Blvd.
Fort Wayne, IN 46804
260-257-2622
srtprosthetics.com

Summit City Prosthetics &
Orthotics
2401 N Glendale Dr., Suite C
Fort Wayne, IN 46804
419-212-2525
summitcitypo.com

Superior Van & Mobility
2218 Contractor's Dr.
Fort Wayne, IN 46818
260-494-1431
superiorvan.com

The Arc of Indiana
143 W Market St., Ste. 200
Indianapolis, IN 46204
317-977-2375
arcind.org

The Arc of Indiana Master Trust
PO Box 1547
Indianapolis, IN 46206
317-977-2375
thearctrust.org

The Arc of LaGrange County
0235 W 300 N
Howe, IN 46746
260-463-1035
arclag.org

The Columbus Organization
1311 W 96th St., Suite 110
Indianapolis, IN 46260
574-551-0252
columbusorg.com

The INDATA Project at
Easterseals Crossroads
4740 Kingsway Dr.
Indianapolis, IN 46205
317-828-4950
eastersealstech.com

The League
5821 S. Anthony Blvd.
Fort Wayne, IN 46816
260-705-1708
the-league.org

The MINDCAP Center
6507 Constitution Dr.
Fort Wayne, IN 46804
260-271-4650
mind-cap.org

Torres Behavioral Health, LLC
1400 Airport North Office Park,
Ste D
Fort Wayne, IN 46825
260-702-9141
torresbehavioralhealth.com

Total Care ABA
211 4th St.
Lawrenceburg, IN 47025
404-400-5004
totalcareaba.com

True North Consulting Group
12219 Golden Harvest Dr.
Fort Wayne, IN 46845
260-467-0090
truenorthin.com

Turnstone
3320 N. Clinton St.
Fort Wayne, IN 46805
260-969-7630
turnstone.org

UniqueHab Solutions
5508 Saint Joe Rd.
Fort Wayne, IN 46835
260-705-2728
uniquehab.com

VA Northern Indiana Health Care
System
2121 Lake Ave.
Fort Wayne, IN 46805
260-249-0634
va.gov

Vernon Health & Rehabilitation
1955 Vernon St.
Wabash, IN 46992
765-669-4841
vernonhealthandreb.org

Visually Impaired Preschool Services
(VIPS Indiana)
1212 Southeastern Ave.
Indianapolis, IN 46202
317-902-0931
vips.org

Volunteer Lawyer Program of
Northeast Indiana
347 W Berry St., Suite 101
Fort Wayne, IN 46802
260-407-0917
vlpnei.org

W.E.L.T. 95.7fm Community Radio
(AppleOrchardKnewz)
342 W Fleming Ave.
Fort Wayne, IN 46807
260-804-1028
weltfm.org

Walgreens

We Carry Kevan
4407 Brookshire Circle
Fort Wayne, IN 46835
336-392-9236
wecarrykevan.org

Window Works
1595 Georgetown Rd.
Hudson, OH 44236
260-442-9252
mywindowworks.com

Writing by Gloria
1124 Putnam St.
Fort Wayne, IN 46808
260-417-0832
writingbygloria.com

YMCA of Greater Fort Wayne
347 W. Berry St., Suite 500
Fort Wayne, IN 46802
260-755-4961
fwymca.org

YOURspace Inc
6320 Highview Dr.
Fort Wayne, IN 46818
260-241-3432
yourspaceinc.com

Everyone Deserves a Voice



Explore AAC options as unique as you.

- Speech-generating devices
- iOS apps
- World-renowned vocabularies
- Multiple access methods
- Unmatched support & training
- Industry-leading High Five Warranty (5 years)



Nicole Smith, M.A., CCC-SLP
AAC Consultant | Northern Indiana
260.388.2350



View AAC devices:
store.prc-salttillo.com



 **prc-salttillo** 800.262.1984 | prc-salttillo.com



YOURspace sensory pods are private soundproof rooms providing relief and peace for neurodiverse individuals experiencing challenging environments.



Homes
Offices
Retail Spaces
Libraries
Universities

Customizable. Flexible. Multiple Sizes.

Peace and Restoration. YOUR way.

yourspaceinc.com/sensory-room-pods

260.702.9595

UniqueHab Solutions



Creating Unique Solutions Together

5508 SAINT JOE ROAD FORT WAYNE | 8345 CLEARVISTA PLACE SUITE 200 INDIANAPOLIS

www.uniquehab.com

UniqueHab Solutions was created to meet the unique needs of families and their loved ones with physical and intellectual disabilities. We are dedicated to enhancing and full filling the dreams and opportunities of children and adults with physical and intellectual disabilities to live as independently as achievable, be included in the community and function at their maximum possible level.

Our Philosophy

- Residential services designed to meet the unique needs of clients and families.
- Services are tailored to assist individuals achieve optimal level of function in community setting.
- Care is based on respect for the dignity and worth of everyone.
- Services will be provided in the least restrictive setting.
- Clients/families are active participants in the care planning process.

For you – RESIDENTIAL Habilitation, COMMUNITY Habilitation, RESPITE Services, HEALTHCARE

Coordination NEEDS: - GIVE US A CALL! WE HAVE UNIQUE SOLUTIONS FOR YOU!!!!



CONTACT INFORMATION

FORT WAYNE 260 203 2077 INDIANAPOLIS 317 436 8472 FAX 260 203 2101 info@uniquehab.com

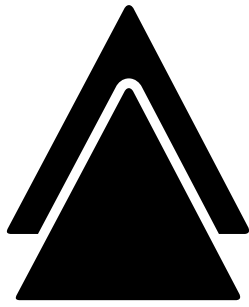

RESCARE[®]

COMMUNITY LIVING

ResCare Community Living, dba ResCare Northern Indiana, serves over 400 individuals with ID/DD and employs over 600 people. Fort Wayne offers ICF services, Waiver and Periodic services, Residential Services, Structured Family Caregiving, Nursing, Wellness Coordination and Transportation.

We are CARF Accredited and offer services within Adams, Allen, Blackford, Dekalb, Delaware, Fulton, Huntington, Jasper, Jay, Kosciusko, Lagrange, Lake, LaPorte, Madison, Marshall, Newton, Noble, Porter, Pulaski, Starke, Steuben, St. Joseph, Wabash, Wells and Whitley counties.

The Fort Wayne operation prides itself on having a longstanding, dedicated leadership team with over 100 combined years of experience. It is a diverse and welcoming operation with:

- Excellent 24/7 on-call nursing and management personnel
- Regional quality nursing support
- Competitive pay for DSP's and Caregivers
- Participates in Special Olympics, volunteering and donating
- Partnered with Western Reserve - Our personal medical team (Nursing/physician care with 24/7 in-home and triage support)

If you are interested in more information please contact our Executive Director, Jaela Nichelson at 260. 704.0634 or jnichelson@rescare.com or visit one of our three locations:

4410 Executive Blvd.
Fort Wayne, IN 46808

527 Park Place
Mishawaka, IN 46545

1620 Country Club Road
Valparaiso, IN 46383

Remote Monitoring Technology with a Personal Touch

Rest Assured[®] blends wireless monitoring and two-way chat with specially trained caregivers to help the individuals you care about stay safe while living as independently as possible.

Learn more: RestAssured.com



Rest Assured[®]
Telecare & Remote Support



Embracing differences. Empowering people.

Easterseals Arc of Northeast Indiana is committed to supporting people with disabilities and leading the way to full equity, access and inclusion.

By offering a wide range of programs and services to meet individual needs, Easterseals is:

- Enriching education
- Enhancing health
- Expanding employment
- Elevating community

Learn more about Easterseals at www.eastersealsnei.org.



Easterseals Arc
Fort Wayne

Easterseals Passages
Columbia City

Easterseals RISE
Angola



Now Hiring!

Visit our website or scan the QR code to apply.

- Competitive Wages
- Paid Orientation
- Merit Raises
- Referral Bonuses



☎ 260.444.3433
 🌐 www.aidofindiana.com
 📍 9434 Lima Road
 Fort Wayne, IN 46825

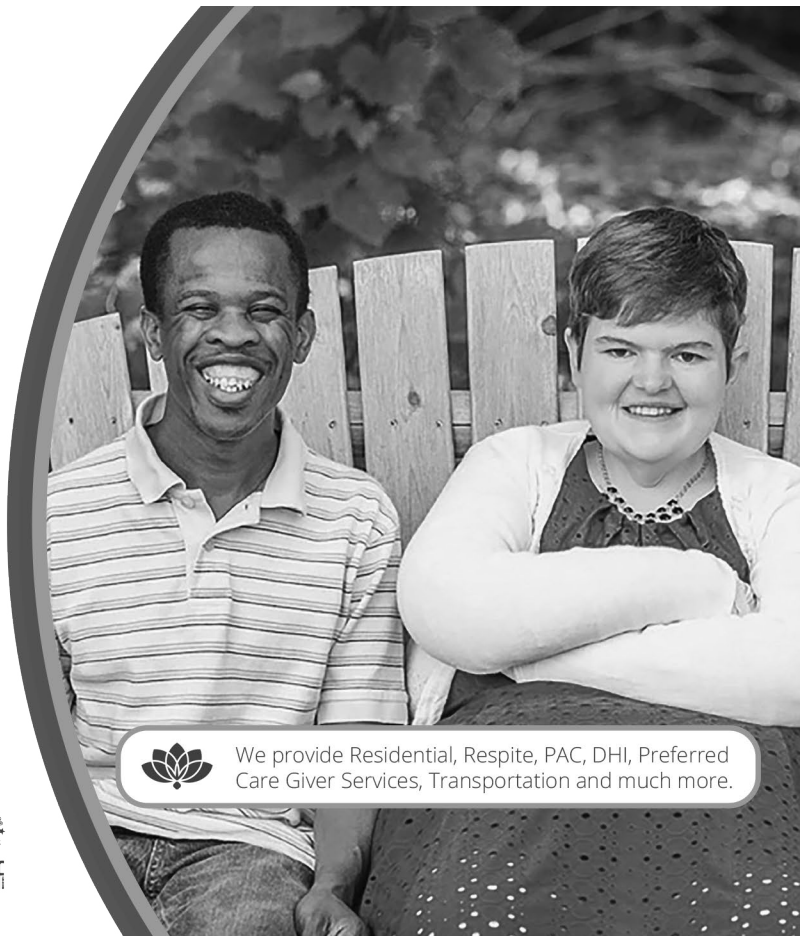

We provide Residential, Respite, PAC, DHI, Preferred Care Giver Services, Transportation and much more.

CONNXXIONS

Coordinated Care for the Dually Diagnosed

For persons with intellectual or developmental disorders and mental health needs.



Individuals with intellectual/developmental disorders and mental health needs face unique challenges.

Meridian Health Services' Connxxions Program is specially designed to improve the individual's coping skills and overall well-being.



Services may include:

- Individual therapy
- Group Skill Building
- Case management
- Mental Health Skill Building
- Psychiatric services
- 24-Hour Crisis Services

*Services do not use Medicaid Waiver funds; They are funded through Medicaid Rehabilitation Option (MRO).

To enroll in the
Connxxions Program
contact
Meridian Health Services at
866-306-2647

MERIDIAN

HEALTH Services

Physical. Mental. Social Well-Being.

MeridianHS.org



Agape Mobility Ethiopia

*No more crawling
on the floor!*

**The gift of mobility
restores dignity and
hope for people
in Ethiopia!**

- Manual wheelchairs
- Aluminum walkers
- Crutches and canes
- Wheelchair parts, such as footrest trays and seat cushions
- Children's orthopedic wheelchairs
- New crutch armpit pads, hand grips, foot tips



Scan for more information.

CONTACT US FOR PICKUP!
(260) 498-7862

agapemobilityethiopia@gmail.com
agapemobilityethiopia.org

LJ'S DISCOUNT MEDICAL
CARING PEOPLE, CARING FOR PEOPLE

*Durable Medical Equipment
Power Mobility
Aids to Daily Living*

737 N. Coliseum Boulevard • Fort Wayne, IN 46805
Tel: 260.444.5105 • Fax: 260.444.5109
www.ljdiscountmedical.net

MOBILITY

- Power Wheelchairs
- Scooters
- Manual Wheelchairs

BATHROOM AIDS

- Raised Toilet Seats
- Grab Bars
- Toilet Safety Frames

ACCESSIBILITY

- Ramps
- Porch Lifts
- Stair Lifts

HOME EQUIPMENT

- Hospital Beds
- Lift Chairs
- Patient Lifts

CONVALESCENT AIDS

- Walkers/Rollers
- Canes/Crutches
- Knee Walkers

Mobility Plus®

scooters • ramps • lifts



220 Frontage Rd Suite A, • Columbia City, IN 46725 • (260) 503-6066

www.mobilityplus.com

Open: Monday - Friday 10am - 5pm • Appointments by phone



LET'S BUILD A COMMUNITY FOR ALL.



**GREATER
FORT WAYNE INC.**

METRO CHAMBER ALLIANCE

**Disabilities
Initiative**

WE HELP LOCAL BUSINESSES CREATE:



**AN INCLUSIVE
WORKFORCE**



**ACCESSIBLE
WORKSPACES**



**A WELCOMING
COMMUNITY**

We're doing our part to create a more inclusive community, inside and outside the workplace. From our own in-house programs to our connections in the business community, we'd love to help your company welcome workers and customers of all abilities.



Learn more at disabilities.gfwinc.com

FIND HELP QUICKLY & EASILY

IndianaDisabilityResourceFINDER.org

Living with a disability can be a challenge. Finding service providers, programs, equipment and community advocates that can help overcome those challenges, shouldn't be. Welcome to FINDER. It's **free**, easy to use and ready to help you.

This online resource gives you 24/7 access to the community resources, training, and events across Indiana that can improve your quality of life. FINDER helps you quickly and easily compile a complete list of resources, tailored just for you.

FINDER covers a wide range of disabilities and topics of interest for every stage of life, including:

Addiction
Advocacy
Basic Needs
Bullying
Communication
Direct Care
Education
Entertainment
Employment

Equipment
Family/Youth Support
Financial Assistance
Guardianship/Alternatives
Healthcare
Housing/Homelessness
Information/Resources
Insurance
Intervention

Legal
Personal Finance
Recreation/Entertainment
Respite Care/PAC
Sexuality
Social Inclusion
Transportation
Veterans



Help others and be part of the team. Submit a listing if you know of a new service or program.

FINDER

INDIANA DISABILITY RESOURCE
Seek. Discover. Connect. Inform.

Funded by AWS Foundation



INDIANA INSTITUTE ON
DISABILITY AND COMMUNITY





Partners in **AUTISM**

FAMILY OWNED • FAMILY FOCUSED



**Apply online or
at our table!**

Hiring for...

- **Employment Specialist**
- **Behavior Consultant**
- **DSP**
- **Behavior Technician**
- **BCBA**